

GATEWAY SAN DIEGO

Intermodal Transportation Center

NewSchool of Architecture and Design, San Diego, CA

Professor: Kurt Hunker Advisor: James Frost, AIA-E

Lead Designer: Yousef Eshmawi

Model Design: Dustan Bagliere

Team: Joel Smith, Scott Young, Giovanni Torres, B. Rae Kim

GATEWAY SAN DIEGO

Intermodal Transportation Center

- **Integrates All Regional Transport**
Air, Rail, Auto, Bus, Shuttle, Taxi
- **Creates Major Urban Park**
Over Parking Garages
- **Develops Iconic Landmark**
As Gateway to San Diego
- **Establishes Large Economic Generator**
Through Multi-use Functions On and Off Site
- **Provides Sustainable Transit Solution**
Reduces Carbon Footprint by Less Auto Trips



GATEWAY SAN DIEGO



EXISTING AIRPORT

GATEWAY SAN DIEGO Location Plan

MCRD

PACIFIC HWY

R/R

WASHINGTON ST

I-5

WASHINGTON ST.

INDIA ST.

URBAN
PARK
OVER
PARKING

GATEWAY
STATION

URBAN
PARK
OVER
PARKING

OPTIONAL
AIRPORT
PARKING

AIRPORT
TERMINAL

GATEWAY
SAN DIEGO
Site Plan



PACIFIC HWY

R/R

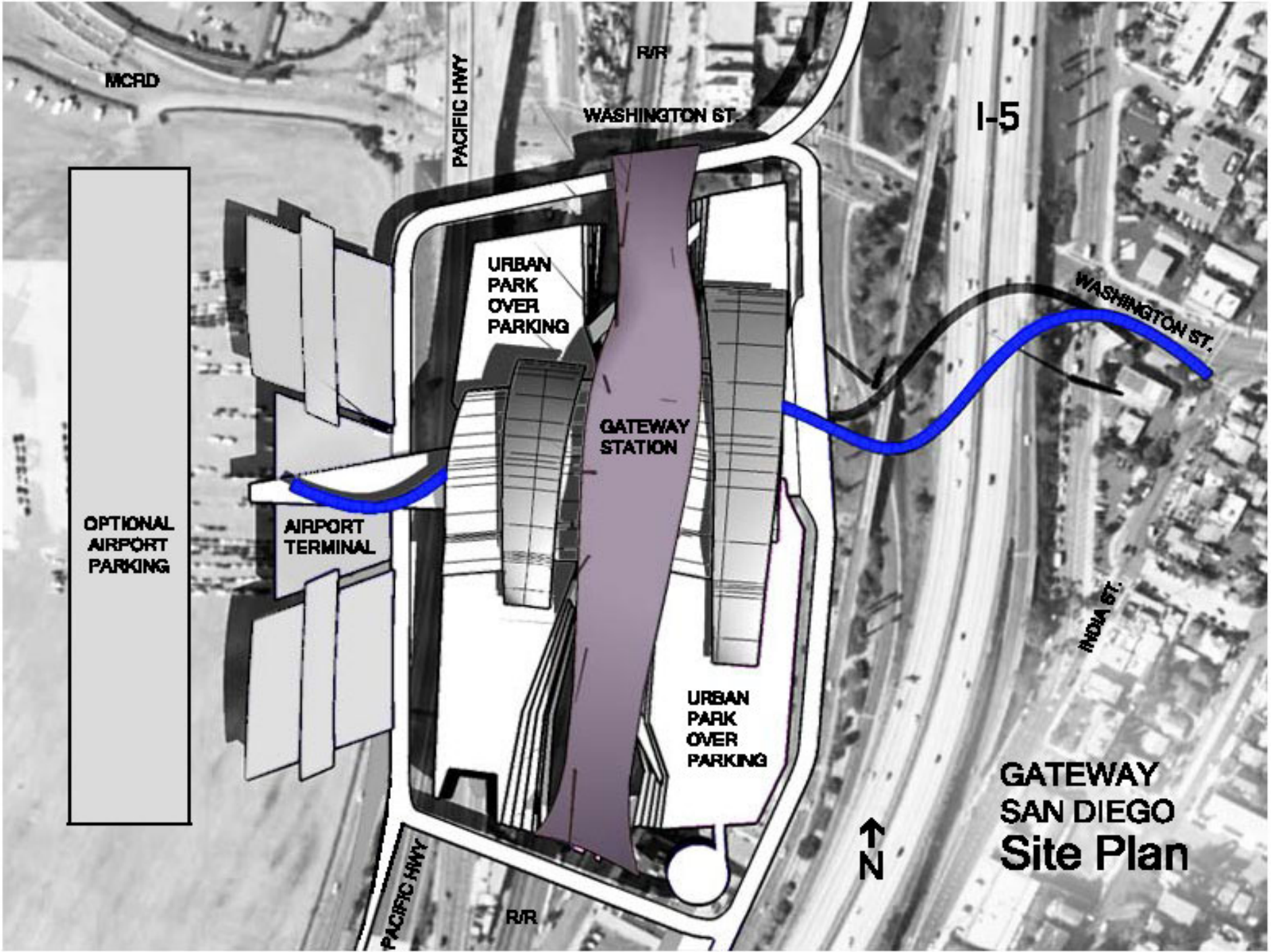

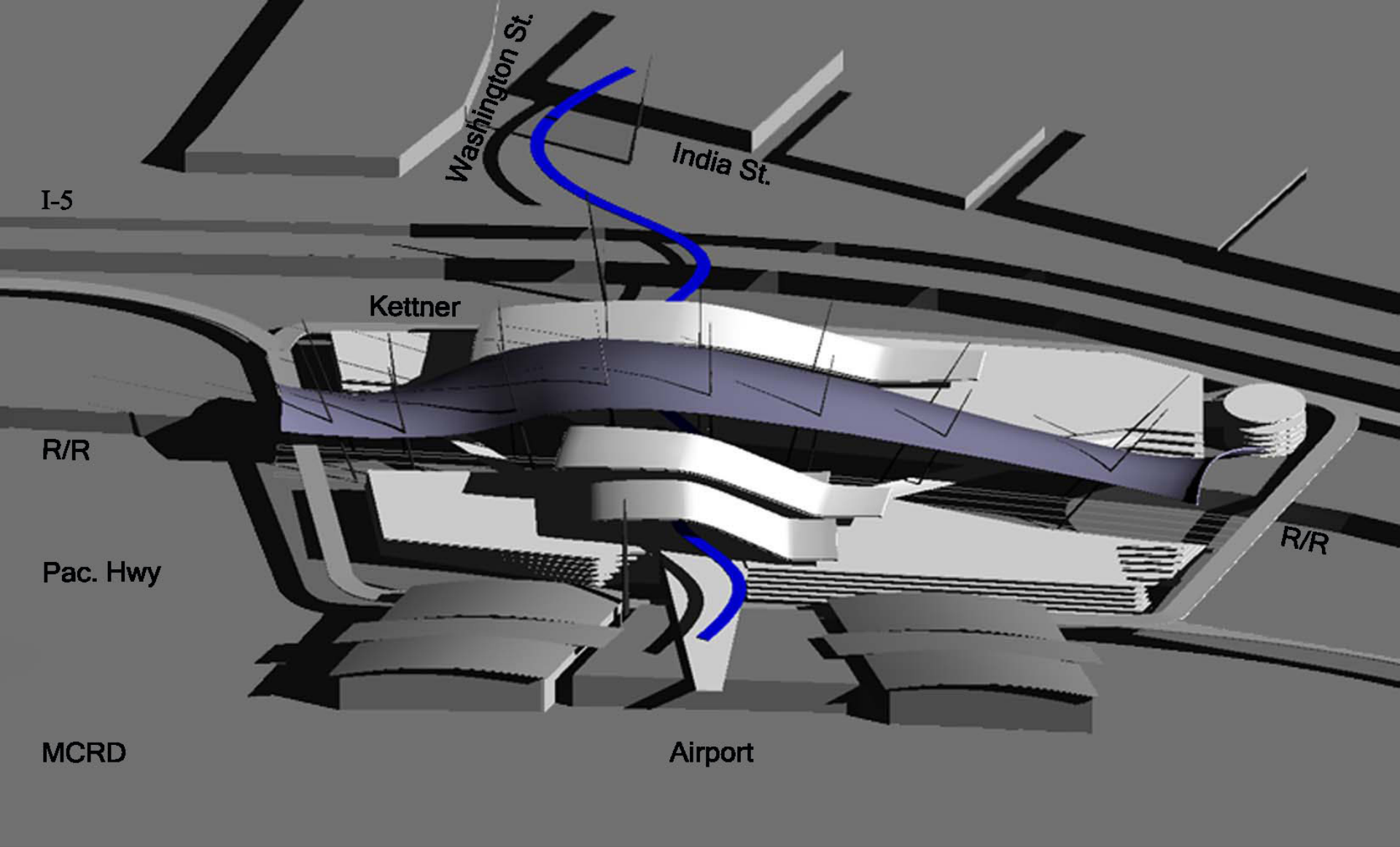

GATEWAY SAN DIEGO
Looking East



GATEWAY SAN DIEGO

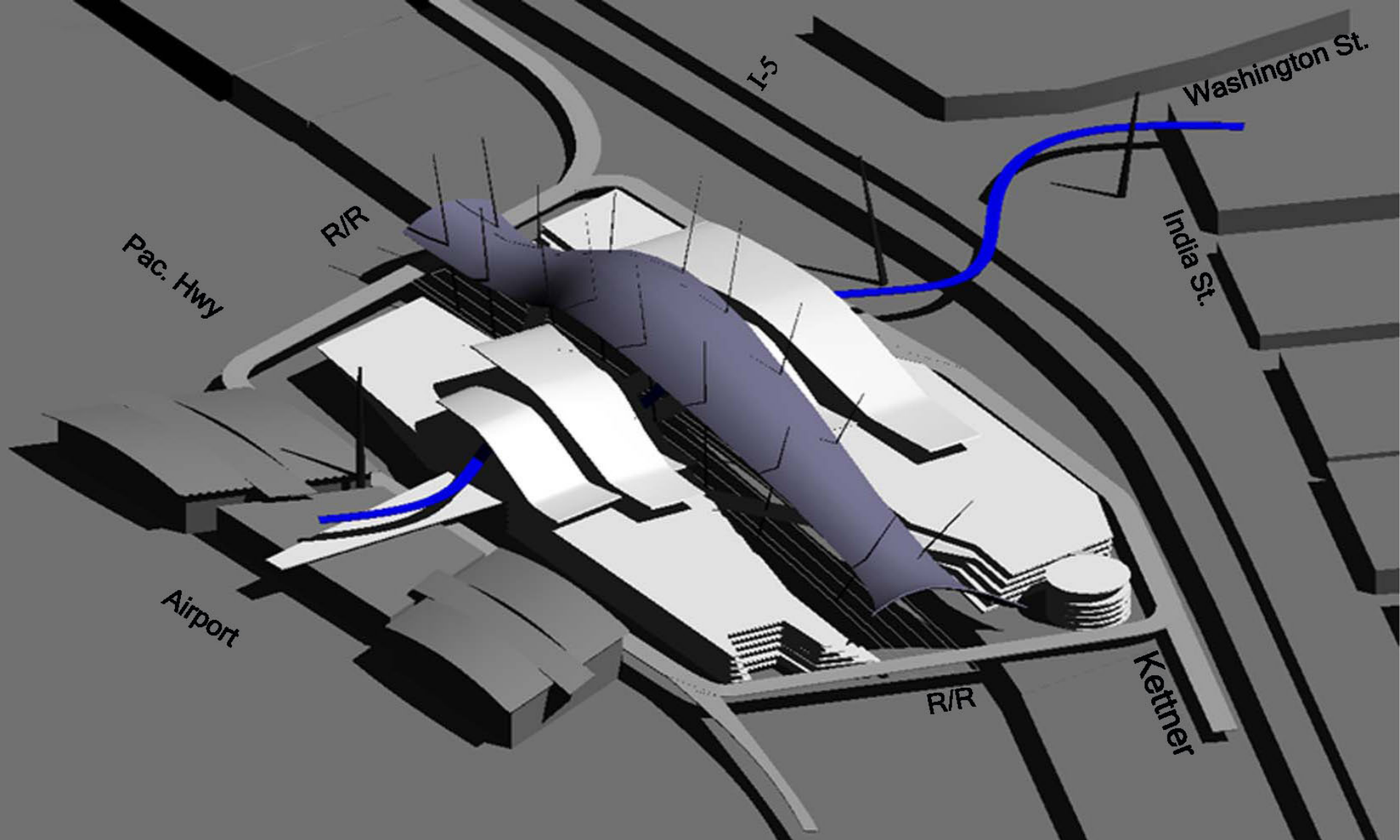

GATEWAY SAN DIEGO
Looking North

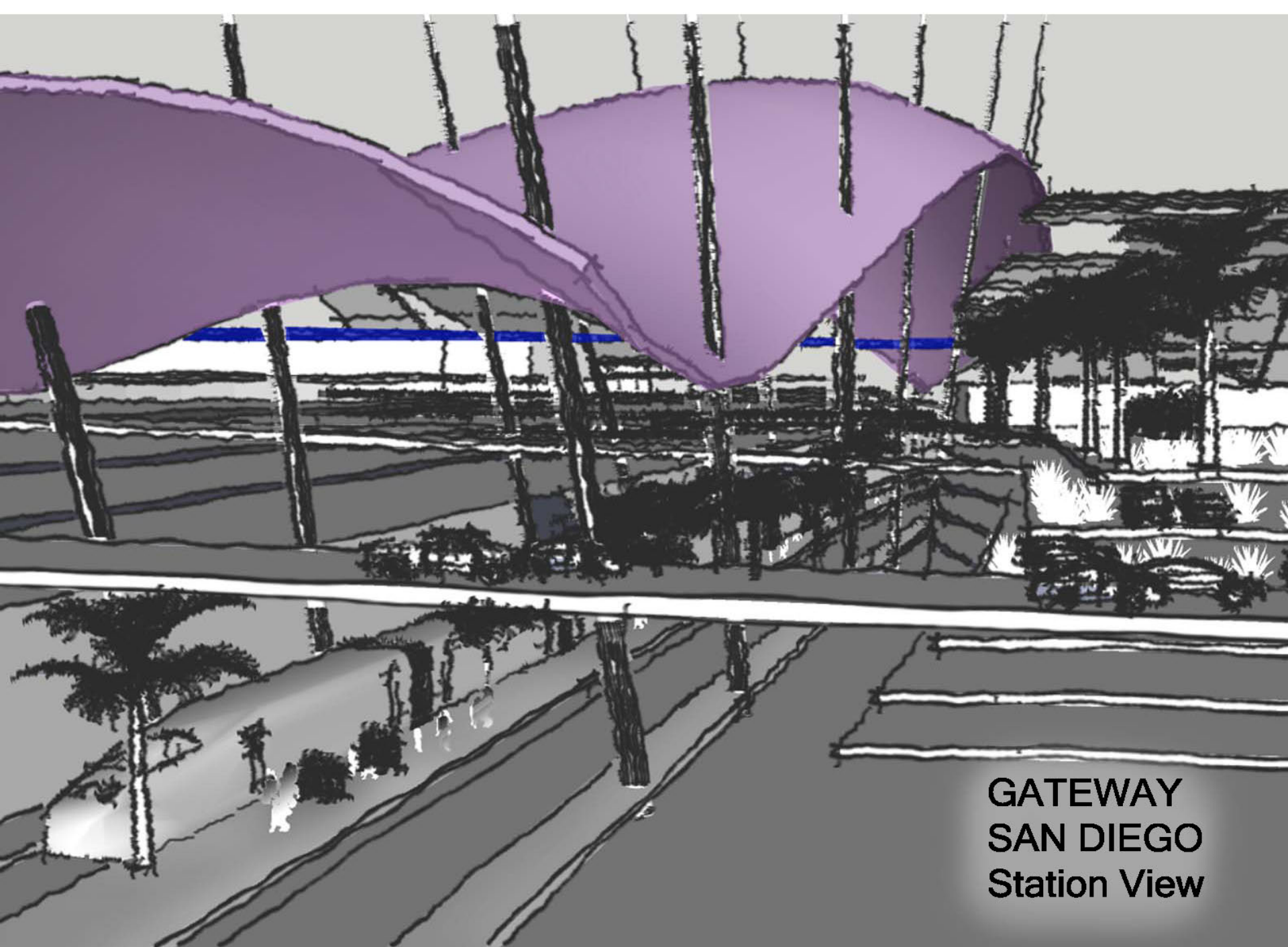

**GATEWAY
SAN DIEGO
Station View**

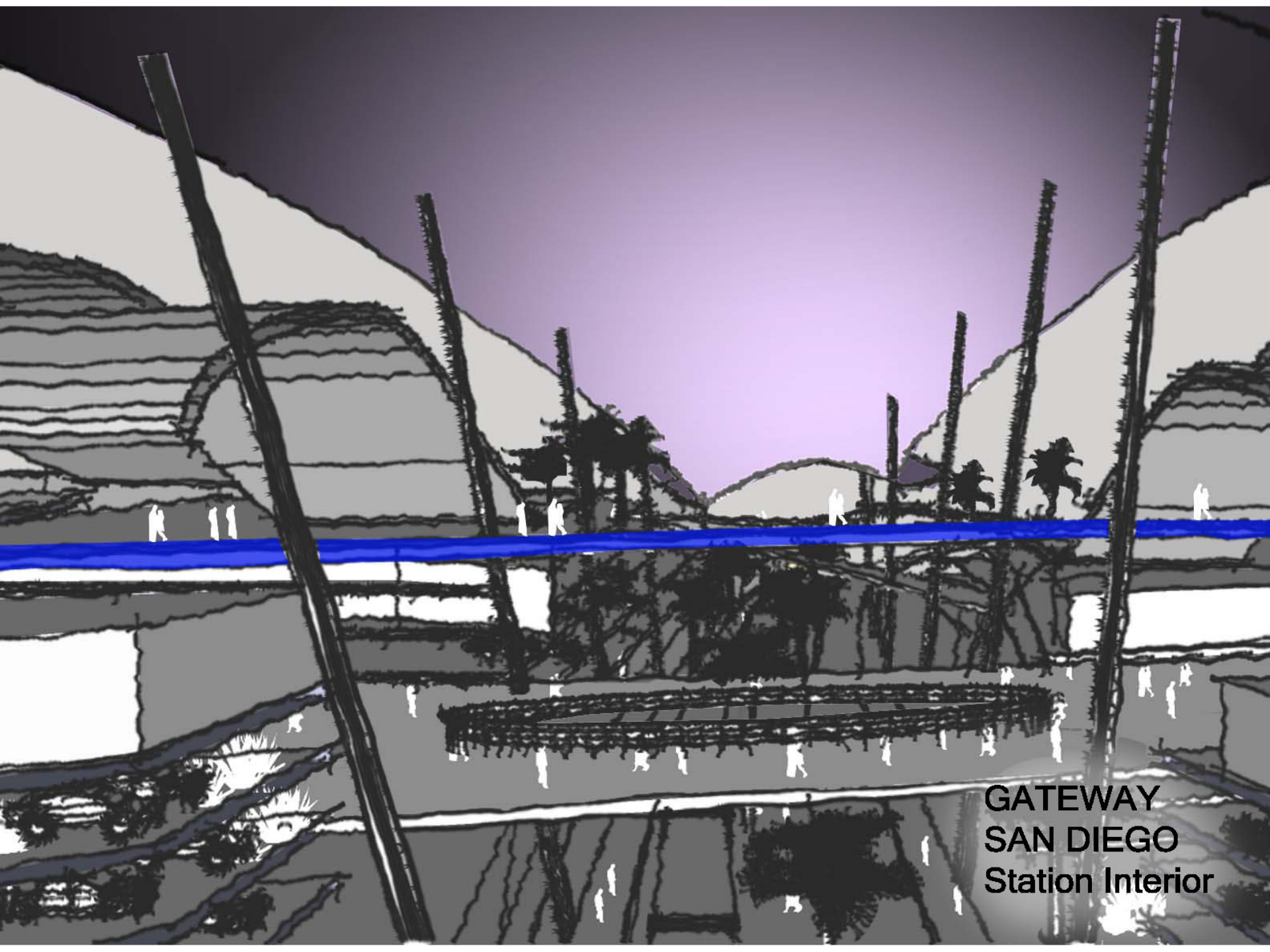

**GATEWAY
SAN DIEGO
Station Interior**

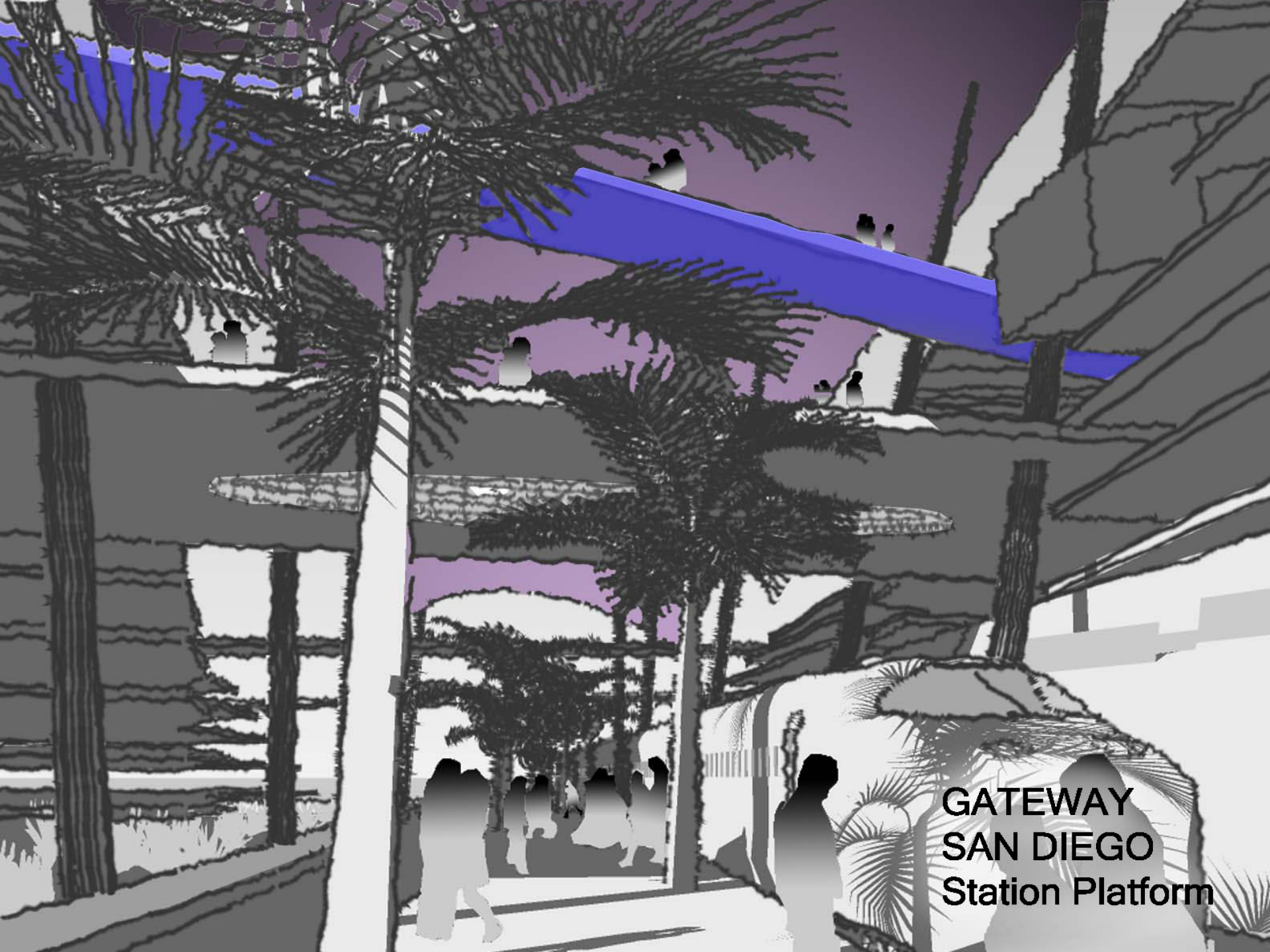

**GATEWAY
SAN DIEGO
Station Platform**

GATEWAY SAN DIEGO

Intermodal Transportation Center

- **Integrates All Regional Transport**
Air, Rail, Auto, Bus, Shuttle, Taxi
- **Creates Major Urban Park**
Over Parking Garages
- **Develops Iconic Landmark**
As Gateway to San Diego
- **Establishes Large Economic Generator**
Through Multi-use Functions On and Off Site
- **Provides Sustainable Transit Solution**
Reduces Carbon Footprint by Less Auto Trips

GATEWAY SAN DIEGO

Intermodal Transportation Center

NewSchool of Architecture and Design, San Diego, CA

Professor: Kurt Hunker Advisor: James Frost, AIA-E

Lead Designer: Yousef Eshmawi

Model Design: Dustan Bagliere

Team: Joel Smith, Scott Young, Giovanni Torres, B. Rae Kim