

Product information



What is a LIME energy saving plug?

The LIME energy saving plug will automatically cut off the electricity to all your connected equipment. The plug can be used with an individual piece of equipment such as a TV or with a number of pieces connected via a multi socket unit.

The plug is controlled by your existing TV remote control (or any Infra-red (IR) remote control). You can select the desired button you wish to use on your remote control and the plug will learn and remember it. This would usually be the on/off button, so that the plug operates when you turn off the TV.

The plug uses an IR receiver which must be placed in the line of sight of the remote control you are using. There is an adhesive patch on the bottom of the IR receiver to secure it, if required, in the correct position.

Simply press the synchronised button on the remote control and the plug will turn off all power to connected equipment. To restore power to the connected appliances press the synchronised button on the remote control.

Instructions for use

The LIME energy saving plug operates with all conventional IR remote controlled appliances such as TVs, DVD player/recorders, stereo systems on a single socket or multi socket extensions. To get started...

1. Plug your electric item(s) into the socket of the LIME energy saving plug (A).
2. Plug the LIME energy saving plug into the wall socket (B).
3. Ensure the IR receiver (C) of the LIME energy saving plug is positioned so it has line of sight with your appliance's remote control.
4. Turn on the mains switch, the unit indicator light (D) will flash slowly.
5. Point your appliance's remote control at the IR reader (C) and hold down the on/off button. The light on the unit will flash quickly and will then go off; your plug is now synchronised.
6. To turn your appliance(s) on, press the synchronised button once. Allow 60 seconds before turning off again.
7. To turn your appliance(s) off, simply press the synchronised button. Allow 60 seconds before turning on again.

To reset or change the synchronised remote control:

Turn on the mains switch, hold the reset button (E) down until the light flashes, and continue from step 5 above.

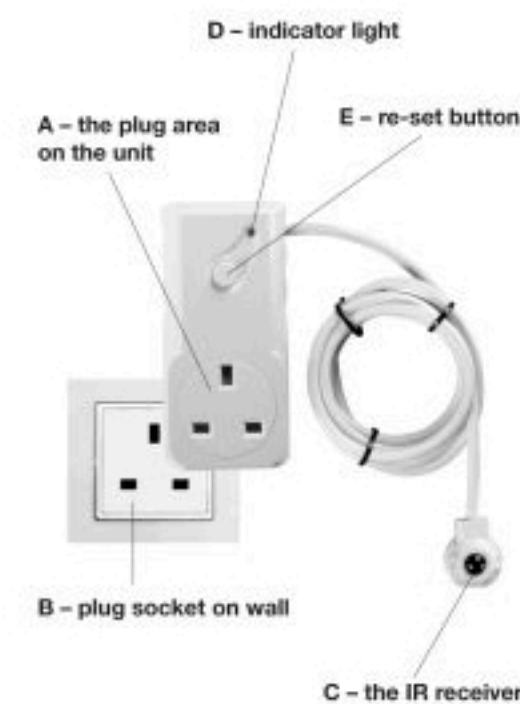

Technical data

Rated voltage 240volts/ 50KHZ
Max Load 13A/3000 watts
Standby power input <0.5watts
1.5 m IR cable
Power On indicator Light
Learning function for any IR button or remote control
Manual on/off button on the unit

Notes

The LIME energy saving plug will shut down all power to items attached to it therefore DO NOT use with:
Fish tanks
Sky+ box
Fridge or freezer
Please refer to relevant product manual before installation.