



Lighting Group

CORE 200 pendant

Description

Mix-and-match a colossal array of finish and color choices to make CORE's sleek design fit in or stand out anywhere - from Art Deco to mid-century modern to futuristic. It's cylindrical awesomeness.

Specifications

Source	Xicato XSM module - 400, 700, 1000 or 1300 lumens
C.C.T.	2700 K, 3000K, 3500K or 4000K
Color Consistency	CCT +/- 50K, Duv +/- .001, 1x2 step MacAdam (1 x 2 SDCM) along BBL
CRI (Ra)	≥80 or ≥ 95
CRI Consistency	+3/-0 points
LED Driver	Canopy or remote mount options
Power	26 watts max, including LED Driver w/ 1300 lm LED Module
Reflector	20°, 40°, 60° or reflector baffle - field replaceable without tools
Material	CNC machined aluminum with stainless steel hardware
Finish	Bead Blasted / Grained / Polished + Anodized
Weight	2.75 lb. [1.25 kg]
Location	Listed for Wet Locations (pending Feb 2012)
Approvals	ETL pending (Feb 2012). Conforms to UL Standards 2108, 8750 and CSA C22.2#250.0
L70 Life	> 50,000 hours at 70% lumen maintenance based on IESNA LM80-2008
Warranty	Lifetime Limited Warranty - see warranty for details
IES Files	Available at www.v2LightingGroup.com

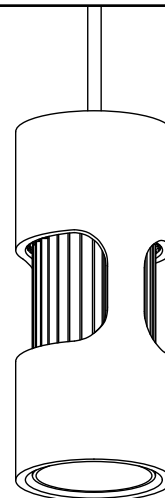

INDOOR OUTDOOR

DIMMABLE

WET
LOCATION



Ordering Logic

Model	Canopy	Driver Location	Dimming	Output	CRI	C.C.T.	Reflector	Cutout	Shell Finish	Shell Color	Heat Sink Color	Cable Color
VC2P	<input type="checkbox"/>	<input type="checkbox"/>	<input type="checkbox"/>	<input type="checkbox"/>	<input type="checkbox"/>	<input type="checkbox"/>	<input type="checkbox"/>	<input type="checkbox"/>	<input type="checkbox"/>	<input type="checkbox"/>	<input type="checkbox"/>	<input type="checkbox"/>
VC2P	S = Shallow D = Deep	R = Remote C = Canopy	N = None P = Phase V = 0-10V	04 = 400 lm 07 = 700 lm 10 = 1000 lm 13 = 1300 lm	80 = Ra≥80 95 = Ra≥95	27 = 2700 K 30 = 3000 K 35 = 3500 K 40 = 4000 K	20 = 20° 40 = 40° 60 = 60° BF = Baffle	N = None R = Round S = Square D = Dual Z = Custom	B = Bead Blast G = Grain P = Polish	XX	XX	BK = Black, All Locations WH = White, All Locations CS = Clear Silver, Damp Loc CB = Clear Braid, Damp Loc

See "CORE Options" @ www.v2LightingGroup.com for explanations and codes for all options

Dimensions

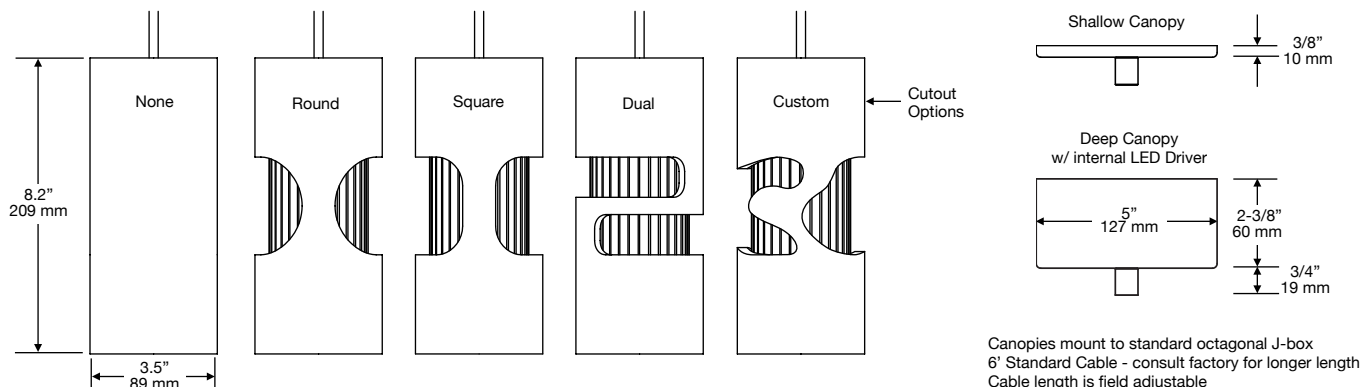

Canopies mount to standard octagonal J-box
6' Standard Cable - consult factory for longer length
Cable length is field adjustable



Lighting Group

CORE 200 sconce

Job :

Project

Type :

Part # :

Description

Mix-and-match a colossal array of finish and color choices to make CORE's sleek design fit in or stand out anywhere - from Art Deco to mid-century modern to futuristic. It's cylindrical awesomeness.

Specifications

Source	Xicato XSM module - 400, 700, 1000 or 1300 lumens
C.C.T.	2700 K, 3000K, 3500K or 4000K
Color Consistency	CCT +/- 50K, Duv +/- .001, 1x2 step MacAdam (1 x 2 SDCM) along BBL
CRI (Ra)	≥80 or ≥ 95
CRI Consistency	+3/-0 points
LED Driver	Remote mount options
Power	26 watts max, including LED Driver w/ 1300 lm LED Module
Reflector	20°, 40°, 60° or reflector baffle - field replaceable without tools
Material	CNC machined aluminum with stainless steel hardware
Finish	Bead Blasted / Grained / Polished + Anodized
Weight	Standard version: 3.25 lb. [1.5 kg] ADA compliant version: 2.9 lb. [1/3 kg]
Location	Listed for Wet Locations (pending Feb 2012)
Approvals	ETL pending (Feb 2012). Conforms to UL Standards 2108, 8750 and CSA C22.2#250.0
L70 Life	> 50,000 hours at 70% lumen maintenance based on IESNA LM80-2008
Warranty	Lifetime Limited Warranty - see warranty for details
IES Files	Available at www.v2LightingGroup.com

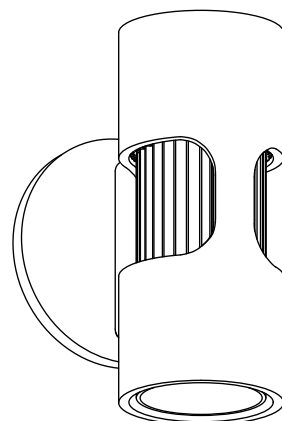

INDOOR OUTDOOR

DIMMABLE

WET
LOCATION



Ordering Logic

Model	Canopy	ADA Compliant	Dimming	Output	CRI	C.C.T.	Reflector	Cutout	Shell Finish	Shell Color	Heat Sink Color
VC2S	<input type="checkbox"/>	<input type="checkbox"/>	<input type="checkbox"/>	<input type="checkbox"/>	<input type="checkbox"/>	<input type="checkbox"/>	<input type="checkbox"/>	<input type="checkbox"/>	<input type="checkbox"/>	<input type="checkbox"/>	<input type="checkbox"/>
VC2S	R = Round S = Square	N = No Y = Yes	N = None P = Phase V = 0-10V	04 = 400 lm 07 = 700 lm 10 = 1000 lm 13 = 1300 lm	80 = Ra≥80 95 = Ra≥95	27 = 2700 K 30 = 3000 K 35 = 3500 K 40 = 4000 K	20 = 20° 40 = 40° 60 = 60° BF = Baffle	N = None R = Round S = Square D = Dual Z = Custom	B = Bead Blast G = Grain P = Polish	XX	XX

See "CORE Options" @ www.v2LightingGroup.com for explanations and codes for all options

Dimensions

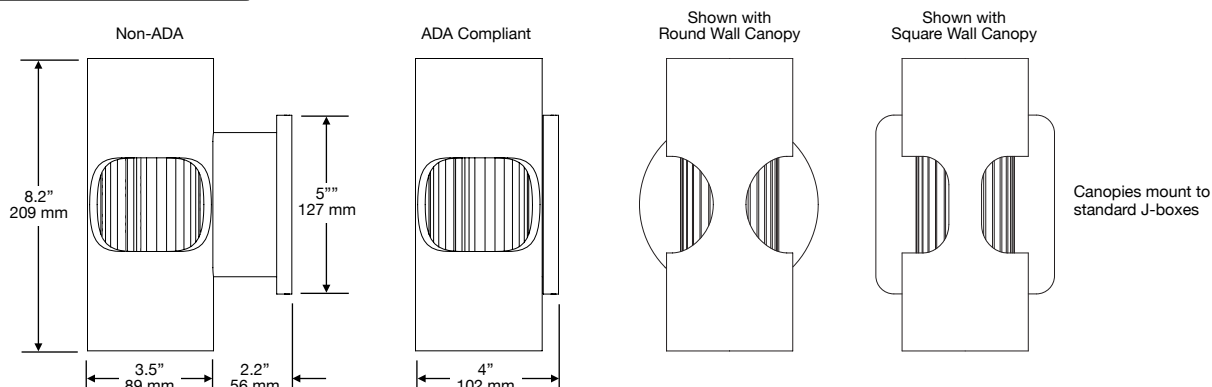



Lighting Group

CORE 300 pendant

Description

Mix-and-match a colossal array of finish and color choices to make CORE's sleek design fit in or stand out anywhere - from Art Deco to mid-century modern to futuristic. It's cylindrical awesomeness.

Specifications

Source	Xicato XSM module - 400, 700, 1000, 1300 or 2000 lumens
C.C.T.	2700 K, 3000K, 3500K or 4000K
Color Consistency	CCT +/- 50K, Duv +/- .001, 1x2 step MacAdam (1 x 2 SDCM) along BBL
CRI (Ra)	≥80 or ≥ 95
CRI Consistency	+3/-0 points
LED Driver	Internal, canopy or remote mount options
Power	42 watts max, including LED Driver w/ 2000 lm LED Module
Reflector	High Efficiency 20°, 20°, 40°, 60° or reflector baffle - field replaceable without tools
Material	CNC machined aluminum with stainless steel hardware
Finish	Bead Blasted / Grained / Polished + Anodized
Weight	6.13 lb. [2.8 kg] add 0.75 lb. [0.34 kg] for internal LED driver
Location	Listed for Wet Locations (pending Feb 2012)
Approvals	ETL pending (Feb 2012). Conforms to UL Standards 2108, 8750 and CSA C22.2#250.0
L70 Life	> 50,000 hours at 70% lumen maintenance based on IESNA LM80-2008
Warranty	Lifetime Limited Warranty - see warranty for details
IES Files	Available at www.v2LightingGroup.com

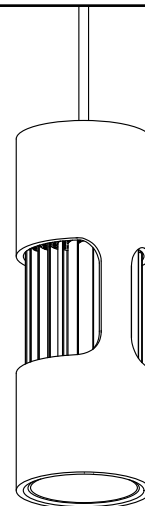

INDOOR OUTDOOR

DIMMABLE

WET
LOCATION



Ordering Logic

Model	Canopy	Driver Location	Dimming	Output	CRI	C.C.T.	Reflector	Cutout	Shell Finish	Shell Color	Heat Sink Color	Cable Color
VC3P	S = Shallow D = Deep	R = Remote C = Canopy N = Internal	N = None P = Phase V = 0-10V	04 = 400 lm 07 = 700 lm 10 = 1000 lm 13 = 1300 lm 20 = 2000 lm	80 = Ra≥80 95 = Ra≥95	27 = 2700 K 30 = 3000 K 35 = 3500 K 40 = 4000 K	2H = 20° High Efficiency 20 = 20° 40 = 40° 60 = 60° BF = Baffle	N = None R = Round S = Square D = Dual Z = Custom	B = Bead Blast G = Grain P = Polish	XX	XX	BK = Black, All Locations WH = White, All Locations CS = Clear Silver, Damp Loc CB = Clear Braid, Damp Loc

See "CORE Options" @ www.v2LightingGroup.com for explanations and codes for all options

Dimensions

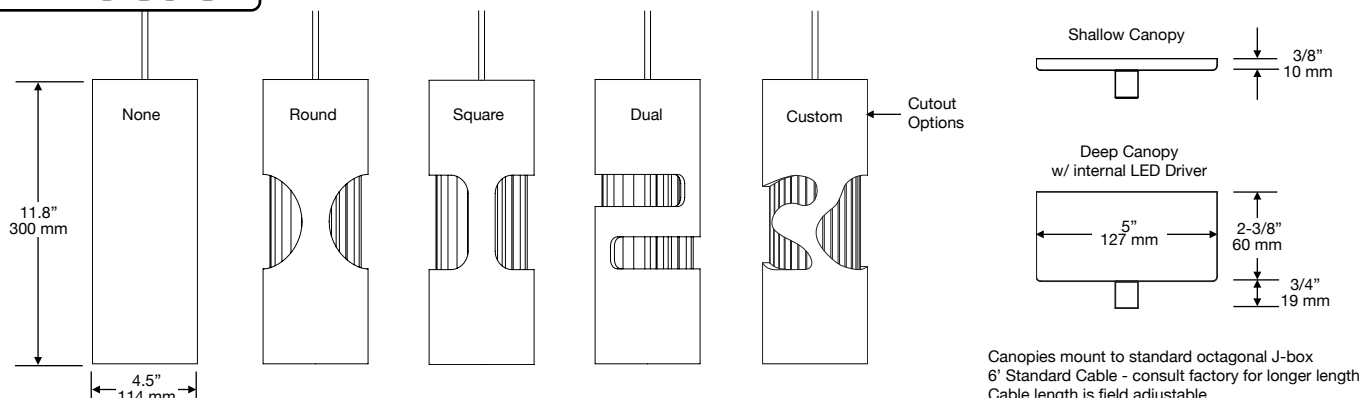



Lighting Group

CORE 300 sconce

Description

Mix-and-match a colossal array of finish and color choices to make CORE's sleek design fit in or stand out anywhere - from Art Deco to mid-century modern to futuristic. It's cylindrical awesomeness.

Specifications

Source	Xicato XSM module - 400, 700, 1000, 1300 or 2000 lumens
C.C.T.	2700 K, 3000K, 3500K or 4000K
Color Consistency	CCT +/- 50K, Duv +/- .001, 1x2 step MacAdam (1 x 2 SDCM) along BBL
CRI (Ra)	≥80 or ≥ 95
CRI Consistency	+3/-0 points
LED Driver	Internal or remote mount options
Power	42 watts max, including LED Driver w/ 2000 lm LED Module
Reflector	High Efficiency 20°, 20°, 40°, 60° or reflector baffle - field replaceable without tools
Material	CNC machined aluminum with stainless steel hardware
Finish	Bead Blasted / Grained / Polished + Anodized
Weight	6.5 lb. [2.95 kg] add 0.75 lb. [0.34 kg] for internal LED driver
Location	Listed for Wet Locations (pending Feb 2012)
Approvals	ETL pending (Feb 2012). Conforms to UL Standards 2108, 8750 and CSA C22.2#250.0
L70 Life	> 50,000 hours at 70% lumen maintenance based on IESNA LM80-2008
Warranty	Lifetime Limited Warranty - see warranty for details
IES Files	Available at www.v2LightingGroup.com

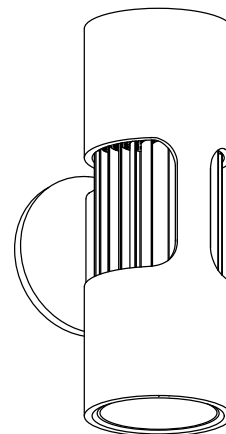

INDOOR OUTDOOR

DIMMABLE

WET
LOCATION



Ordering Logic

Model	Canopy	Driver Location	Dimming	Output	CRI	C.C.T.	Reflector	Cutout	Shell Finish	Shell Color	Heat Sink Color
VC3S	<input type="text"/>	<input type="text"/>	<input type="text"/>	<input type="text"/>	<input type="text"/>	<input type="text"/>	<input type="text"/>	<input type="text"/>	<input type="text"/>	<input type="text"/>	<input type="text"/>
VC3S	R = Round S = Square	R = Remote N = Internal	N = None P = Phase V = 0-10V	04 = 400 lm 07 = 700 lm 10 = 1000 lm 13 = 1300 lm 20 = 2000 lm	80 = Ra≥80 95 = Ra≥95	27 = 2700 K 30 = 3000 K 35 = 3500 K 40 = 4000 K	2H = 20° High Efficiency 20 = 20° 40 = 40° 60 = 60° BF = Baffle	N = None R = Round S = Square D = Dual Z = Custom	B = Bead Blast G = Grain P = Polish	XX	XX

See "CORE Options" @ www.v2LightingGroup.com for explanations and codes for all options

Dimensions

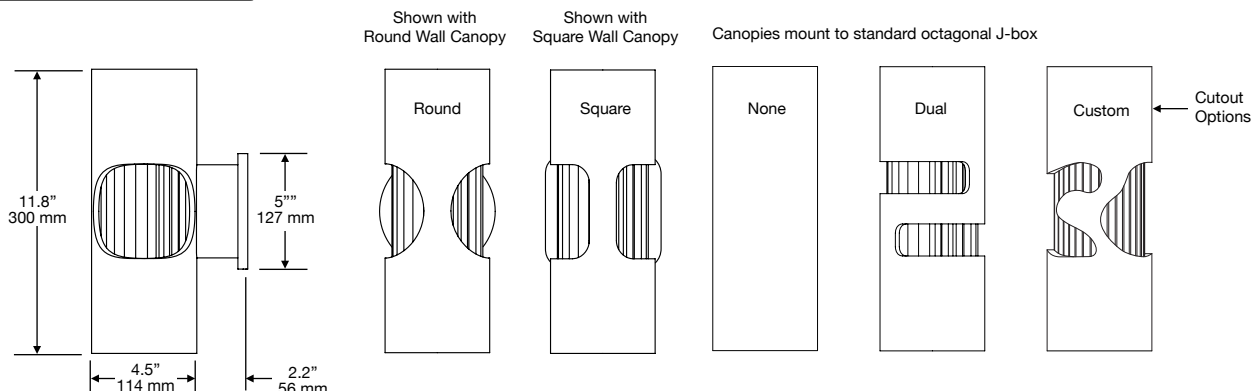



Lighting Group

CORE canopy options

Job :

Project

Type :

Part # :

Pendant - Ceiling Canopy Options:

S = Shallow

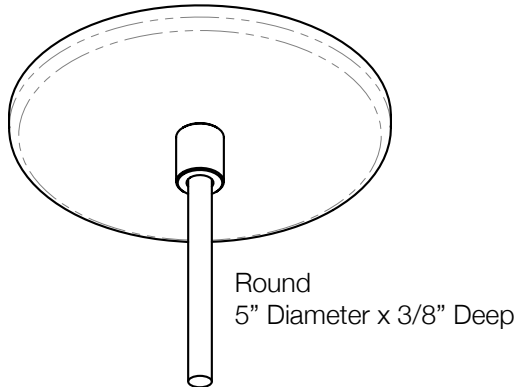

D = Deep

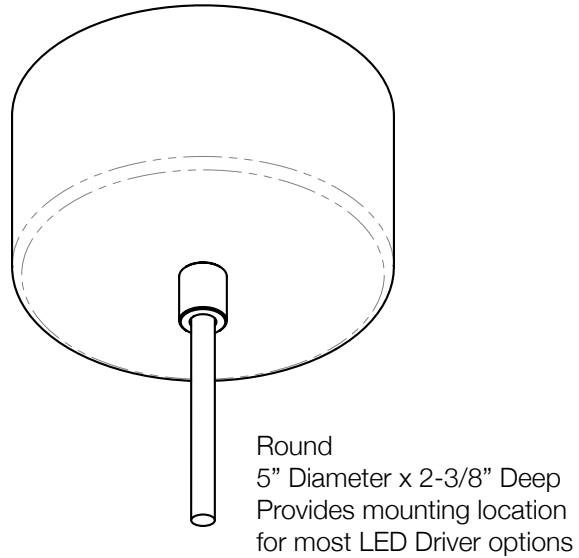

Sconce - Wall Canopy Options:

R = Round
5" Diameter x 1/2" Deep

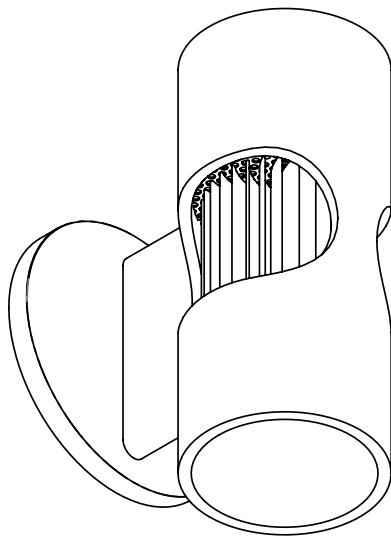

S = Square
5" x 5" x 1/2" Deep

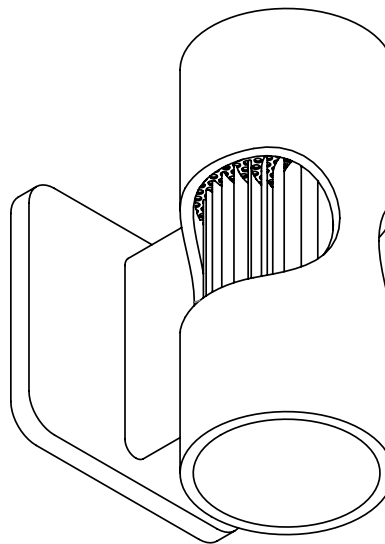



Lighting Group

CORE LED options

Job :

Project

Type :

Part # :

LED Options:

Flux	CRI (Ra)	Wattage	2700K	3000K	3500K	4000K
400lm	≥80	6W	✓	✓		✓
700lm	≥80	12W	✓	✓		✓
700lm	≥95	14W	✓	✓		✓
1000lm	≥80	18W	✓	✓	✓	✓
1000lm	≥95	22W	✓	✓	✓	✓
1300lm	≥80	21W	✓	✓	✓	✓
2000lm*	≥80	36W	✓	✓	✓	✓

*2000lm LED module may only be specified in CORE 300 luminaires with 367W or 40W LED Driver

LED Driver Options:

Wattage	Dimming	LED	Remote Mount	Pendant Deep Canopy Mount	CORE 300 Internal Mount
25W	None	≤ 1300lm	✓	✓	✓
24W	Phase Control	≤ 1300lm	✓	✓	✓
25W	0-10V	≤ 1300lm	✓	✓	
40W	None	≤ 2000lm	✓	✓	✓
36W	Phase Control	≤ 2000lm	✓		
40W	0-10V	≤ 2000lm	✓	✓	

Notes:

- 1) CORE 200 LED drivers must be mounted remotely or in Deep Pendant Canopy
- 2) CORE 300 LED drivers may be mounted internally in luminaire as noted in chart
- 3) Phase control drivers work with forward or reverse phase control dimmers down to 10%
- 4) Multi fixture remote LED drivers are available -please consult factory for details



Lighting Group

CORE reflector options

IES files available at
www.v2LightingGroup.com

Job : _____

Type : _____

Part # : _____

Ordering #	Beam Angle	Image	Polar Graph	Description	CORE 200	CORE 300
20	20°			CBCP = 3195 cd/klm Beam Angle (FWHM) = 21° Field Angle = 63° 70mm x 42mm	✓	✓
40	40°			CBCP = 1607 cd/klm Beam Angle (FWHM) = 43° Field Angle = 73° 70mm x 42mm	✓	✓
60	60°			CBCP = 1050 cd/klm Beam Angle (FWHM) = 59° Field Angle = 86° 70mm x 42mm	✓	✓
BF	n/a		n/a	Reflects 50% of lumen output internally to uplight the heat sink. Downlight is soft and pattern-free. 76mm x 38mm	✓	
2H	20°			CBCP = 3929 cd/klm Beam Angle (FWHM) = 20° Field Angle = 40° 95mm x 83mm		✓
BF	n/a		n/a	Reflects 50% of lumen output internally to uplight the heat sink. Downlight is soft and pattern-free. 100mm x 68mm		✓



Lighting Group

Project

Job :

Type :

Part # :

CORE shell & cable options

Shell Finish Options:

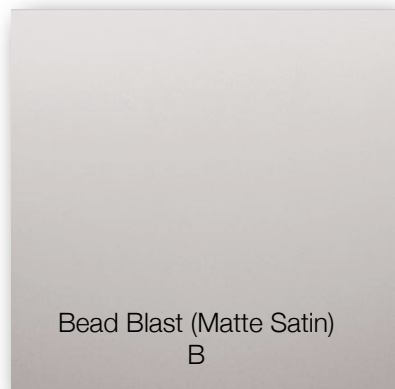

Shell Cutout Options:

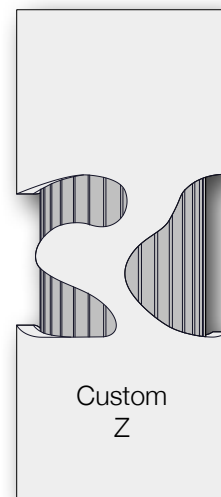
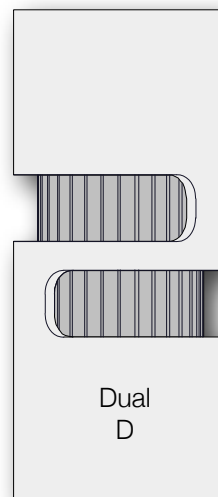
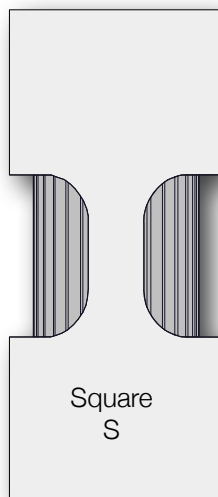
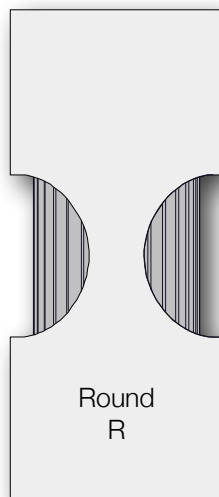
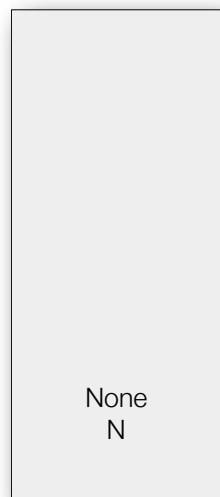

Pendant Cable Color Options:



Black
BX

For all locations



White
WH

For dry and
damp locations



Clear Silver Twist
CS

For dry and
damp locations

Clear jacket
over tinned
copper wire



Clear Silver Braid
CB

For dry and
damp locations

Clear jacket
over tinned
copper braid



Lighting Group

Project

Job :

Type :

Part # :

CORE color options

All colors are anodized except for powder coat as noted

UV Resistant Colors	Clear Silver CL	Grey 1 G1	Grey 2 G2	Grey 3 G3	Black BK	Printed or on-screen colors are only approximations. Consult chip set before specifying.
	Champagne B1	Light Bronze B2	Med. Bronze B3	Dark Bronze B4	Gloss White Powder Coat GW	
	Fiery Red FR	Bordeaux Red BX	Burgundy BU	Deep Orange DO	Light Orange LO	
	Gold AU	Deep Yellow DY	Yellow Green YG	Bright Green GR	Olive Green OG	
	Teal TL	Turquoise TQ	Blue Grey BG	Medium Blue MB	Deep Blue DB	
	Magenta MG	Pink PK	Charcoal Grey CG	Gunmetal GG	Brown BR	
					Olive Brown OB	