



Instructions for Installation of EEP's LED fixture

Warning: This fixture is for use with LED lighting only. DO NOT USE THIS FIXTURE WITH CONVENTIONAL FLUORESCENT BULBS.

Ensure the fixture is installed properly with the use of a licensed electrician in compliance with all codes that apply.

This fixture is designed to accommodate LED light fixture EEP-110UL-D34-4 or equivalent 4-foot LED tube lights. These bulbs operate with an input voltage of 100V-277VAC 50/60Hz. Do not use this fixture with other LED bulbs outside this range and ensure the input voltage is not less than or more than the listed input voltage.

Installation instructions: (please refer to the attached sketch)

1. Remove the LED bulb (item 7). If the LED bulb is in place in the fixture turn the bulb one quarter turn and pull the bulb straight up from the fixture. This will release the bulb from the bulb holders (item 5).
2. Remove the fixture top (item 3) by turning each turn fastener a quarter of a turn (item 6). This will release the fixture top from the fixture.
3. Ensure all supply power is turned off before making any electrical connections.
4. With the fixture top removed using self-tapping screws or other fasteners (not supplied) attach the fixture to the surface you want the fixture affixed to. Use at least four self tapping screws appropriate for the material you are fastening the fixture to. Equally space the screws along the fixture.
5. On one end of the fixture one of the bulb holders will have two wire leads coming from the bottom of the holder.
6. Connect your neutral wire from your power supply to either lead. (All connections must be done by a licensed electrician in compliance with codes.)
7. Connect the hot live wire from your power supply to the other lead.
8. On each use the appropriate connectors and use the knock outs and connection hardware (not supplied) to secure your power supply wire in place per your code requirements.
9. On the same end of the fixture there is green ground screw with a wired connector. Ensure the fixture is properly grounded using this wired connector by connecting the bare copper ground wire from your power supply to the housing.
10. With the fixture mounted and the connections made, replace the fixture top (Item 3) on the fixture by inserting the quarter fasteners (Item 6) and turning them so they lock the top in place.
11. Once the top is in place install the proper LED bulb, by sliding the prongs on each side of the bulb into the slots on the bulb holders and twisting the bulb a quarter turn. Ensure the LEDs are facing away from the fixture top.

LED Light Fixture Assembly

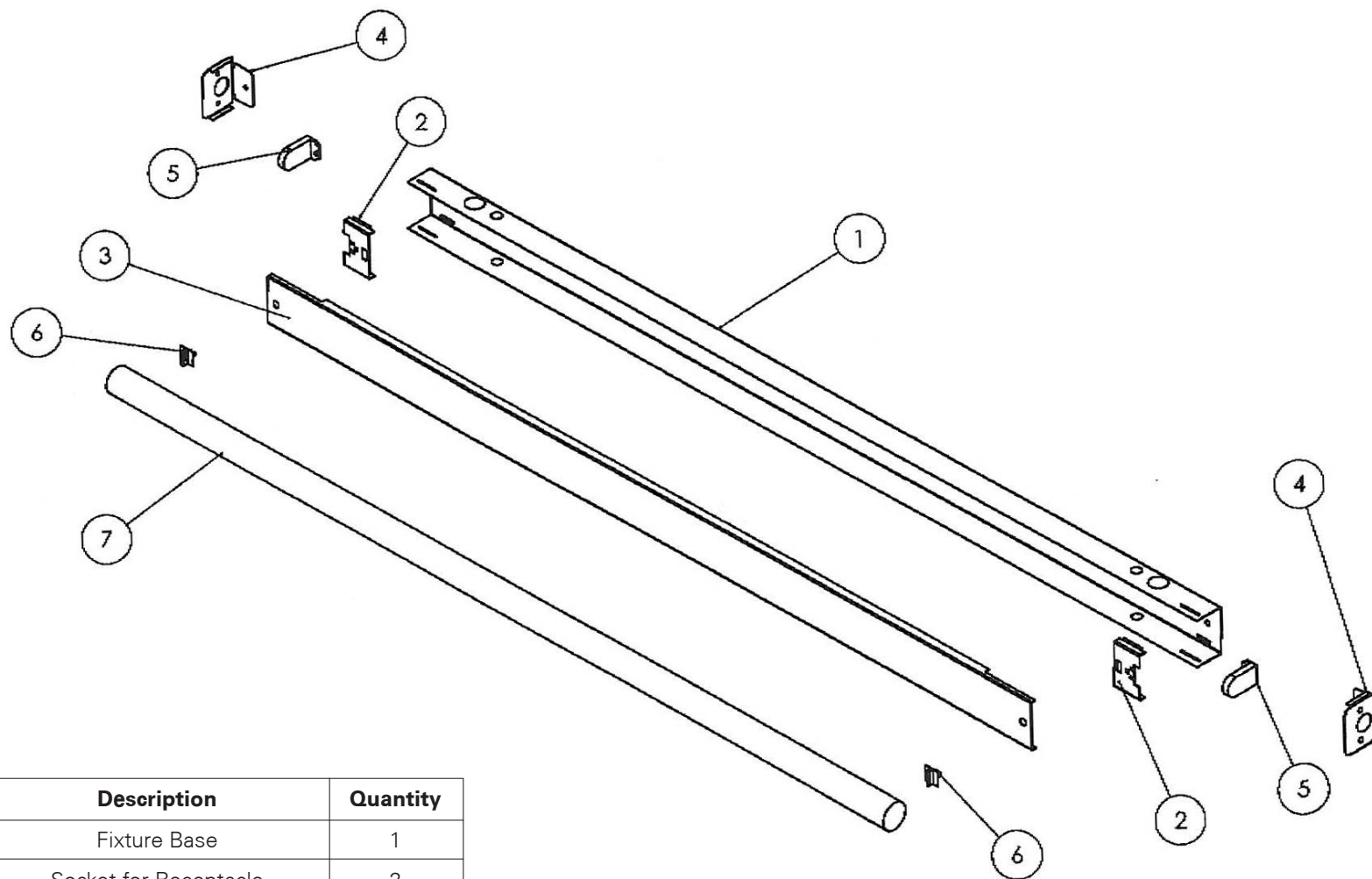

Item No.	Description	Quantity
1	Fixture Base	1
2	Socket for Receptacle	2
3	Fixture Top	1
4	End Caps	2
5	Leviton Unshunted bulb holder	2
6	Quarter Turn Fastener	2
7	0 LED Bulb	1