

Axiom AMI
with wireless link 

StoneL[®]

Easy, safe and
secure remote
access





Axiom AMI with wireless link

Easily access hard-to-reach automated valves

Discover convenient remote access of your automated valves when you install the Axiom AMI with AS-Interface featuring *Bluetooth*® technology.

With the new patent pending **StoneL wireless link** app you can remotely:

- Monitor and set open and closed switch positions
- Monitor and set the network address
- Operate solenoid valve(s) (if network- or power supply-enabled)
- Identify model and serial number (preset from factory)
- Identify valve automation components (entered by valve supplier)
- Log maintenance information
- Monitor diagnostics (valve cycle count, electronics temperature, and more).

Devices may be remotely accessed from up to 50 meters depending on obstructions. Setting changes and solenoid control are enabled through the AS-Interface network or by the power supply jumper.

Interfacing devices

Conventional Apple® devices may be used including:

- iPhone® Version 4S and above
- iPad® Version 3.0 and above
- iPad mini™ All

Contact StoneL regarding additional devices and special enclosures to make these devices suitable for use in hazardous locations.



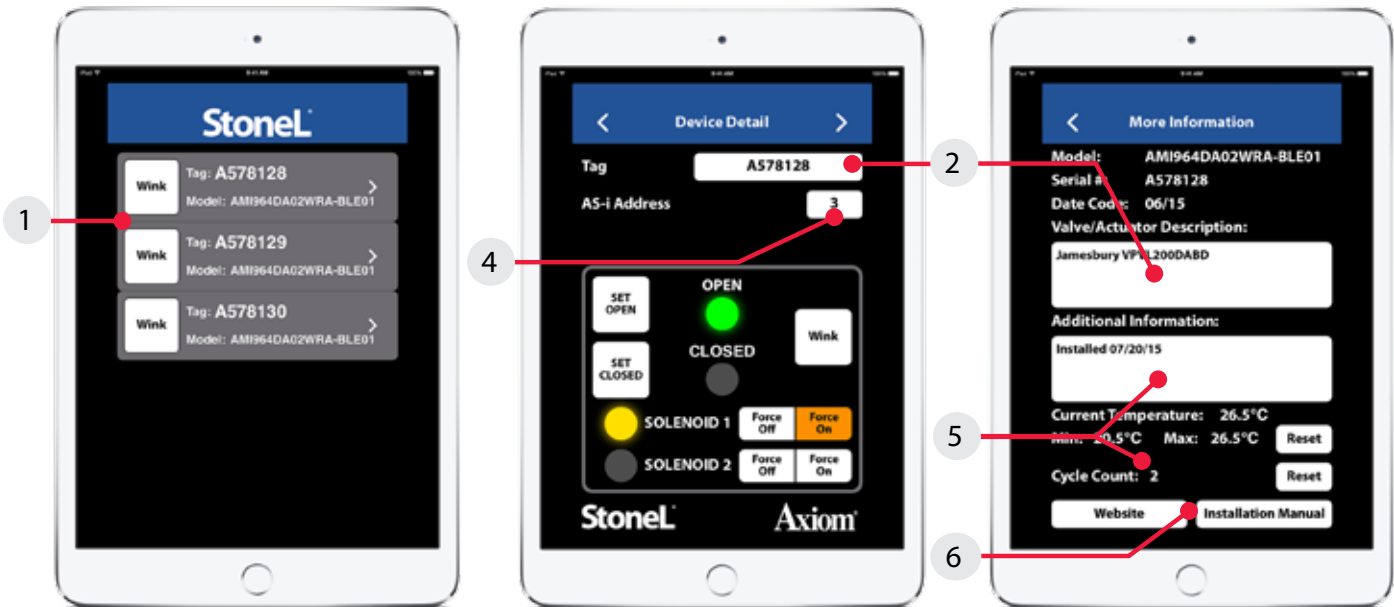

Benefits of wireless link

- Fast, convenient set-up** for valve automation suppliers without special equipment.
- Electronically enter and store** key automated valve system information including:
 - End user tag number/information
 - Valve and actuator identification as well as Axiom model and serial number (Axiom information preset from factory)
 - Maintenance log.
- Improve safety** by easily accessing hard-to-reach automated valves without putting plant personnel at risk.
- Reduce network commissioning time** by accessing the VCT address and making changes if necessary.
- Reduce maintenance time** by monitoring valve cycle count, storing maintenance logs, and accessing multiple valves from one location.
- Conveniently retrieve installation manuals** and StoneL website when connected to internet.

Set up and operation

The Axiom AMI with wireless link is commissioned and set up identically to the standard AS-Interface unit. In addition, when powered up with a conventional power source or by the network, it may be accessed by standard iOS devices. The Axiom is accessed with the *Bluetooth®* Smart protocol using the StoneL wireless link application. Sequence of operation is:

- Download the StoneL application from the App Store onto your device (free of charge)
- Start the application in your Apple® device
- All energized Axiom AMI wireless modules in range will come up
- Push wink to positively confirm the device you have linked (Axiom LEDs will flash)
- Touch the specific Axiom ID/tag to link with your handheld.

You can then monitor all status and diagnostic information and make necessary information changes to the free form fields at any time. Switch settings, address changes, and solenoid operation may be performed only if network- or power supply-enabled. Other information may also be added to the free form fields.

Specifications	
Standard specifications apply to Axiom AMI96_ _ _ _ _W_ _ models and AMI97. Additional specifications for wireless link are as follows:	
Protocol	<i>Bluetooth®</i> Smart technology; Single mode (not compatible with <i>Bluetooth®</i> Classic)
Transmit power	4 dBm or ~2.5 milliwatts
Data rate	1Mbit/second; effective information transmit rate ~10 Kbits/second
Range	Up to 100 meters (330 feet) in free space. Range is reduced by obstructions between handheld device and VCT. Line of sight is not necessary.
Registrations	FCC, IC, CE
CE compliance	Exceeds industrial compliance standards
VCT identification	VCTs in range will be displayed
VCT link	One device accessed at a time between client (handheld device) and server (VCT). Each server accessed by one client at a time.
Application	"StoneL Wireless Link" available from the App store
Handhelds	iPhone® version 4S or above, iPad® version 3.0 or above, and iPad mini™ all versions

Model selector		
SERIES		
AMI	Nonincendive	
FUNCTIONS		
Valve communication Terminals (VCTs)		
96	AS-Interface	
97	AS-Interface with extended addressing	
PNEUMATIC VALVE		
No external override		
1D	Single pilot, 24 VDC (0.5 watt)	
1B	Single pilot, 1.8 W 24 VDC	
2D	Dual pilot, 24 VDC (0.5 watt)	
2B	Dual pilot, 1.8 W 24 VDC	
External override		
3D	Single pilot, 24 VDC (0.5 watt)	
3B	Single pilot, 1.8 W 24 VDC	
4D	Dual pilot, 24 VDC (0.5 watt)	
4B	Dual pilot, 1.8 W 24 VDC	
Latching external override		
5D	Single pilot, 24 VDC (0.5 watt)	
5B	Single pilot, 1.8 W 24 VDC	
ENCLOSURE		
A	North American (NEC/CEC)	
V	International (IEC)	
L	Brazilian	
CONDUIT/CONNECTORS		
Standard		
02	(2) ½" NPT	
05	(2) M20	
Mini-connectors		
10	(1) 4-pin	
11	(1) 5-pin	
19	(1) 6-pin	
20	(1) 7-pin	
21	(1) 8-pin	
Micro-connectors		
13	(1) 4-pin	
15	(1) 5-pin	
17	(1) 6-pin	
18	(1) 8-pin	
CAPABILITIES		
W	Wireless Link [patent pending]	
VISUAL INDICATOR		
RA	Red closed/green open	
GA	Green closed/red open	
1A	Three-way flow path	
2A	Three-way flow path	
XA	Special	
Model number example		
AMI	96	1B A 02 W RA
OPTIONAL OR -T		
MODEL NUMBER	PARTNERSHIP ID	TEMPERATURE
Mounting hardware required and sold separately.	Some models may include 5-digit identification suffix.	Specify -T suffix for extended temperature.

Apple, the Apple logo, iPhone, iPad, and iPod touch are trademarks of Apple Inc., registered in the U.S. and other countries. App Store is a service mark of Apple Inc.

The Bluetooth® word mark and logos are registered trademarks owned by Bluetooth SIG, Inc. and any use of such marks by StoneL® is under license. Other trademarks and trade names are those of their respective owners.

StoneL®

Valve Communication Solutions

26271 US Highway 59, Fergus Falls, MN 56537
USA

Tech hotline 1-218-737-0701

Tel. 1-218-739-5774, fax 1-218-739-5776

Email: sales@stoneL.com

StoneL.com

Publication Number
VP-713-08/15