

24" Marvel Outdoor Refrigerator and Freezer with Ice Maker Option

Model # MO24RF****



- CSA certified for outdoor use to withstand elements like rain, high humidity and heat
- Tested to perform in temperatures as high as 115°F
- Corrosion-resistant stainless steel exterior, commercial-grade 6-foot power cord, sturdy pro-style handle and rugged stainless steel toe kick
- Dynamic Cooling Technology™ delivers rapid cooldown and the industry's best temperature stability
- MARVEL Intuit™ Integrated Control ensures precise refrigeration temperature management from 34° to 42°F to chill drinks and preserve the freshness of food, and freezer temperature can be set from -6° to 6° F to keep contents evenly frozen
- MaxStore™ roller-glide clear-view bin provides maximum capacity to conveniently store and access loose produce, bottles, cans, wine bottles and other miscellaneous items
- Adjustable cantilever shelving allows easy customization to meet your changing storage needs
- Pristine arctic white interior is easy to wipe clean, even in the corners
- Efficient white LED lighting brightly illuminates interior for better viewing of contents
- Interior 1 cu. ft. freezer with self-closing door is large enough to hold up to 12 pints of ice cream
- Optional ice maker kit available to produce and store up to 13 lbs of crescent ice (Accessory part #S42418151, Field Installable)
- Close Door Assist System™ gently and automatically finishes closing door
- Audible and visual alarms signal when door is left ajar to protect food freshness and minimize energy use
- Vacation/Sabbath mode conserves energy during times when the unit is not in use and complies with Sabbath requirements
- Door lock provides added security
- Height adjustment up to 1" with leveling legs
- 4" adjustable stainless steel toe kick
- 1-year parts and labor warranty, 5-year sealed system warranty



Optional Ice Maker

Storage Capacity

Refrigerator: 3.9 cu. ft. (Holds up to 72 12-oz cans)
Freezer: 1 cu. ft. (Holds up to 12 pints of ice cream)

Storage Configuration

- (2) partial-width cantilever, fully adjustable stainless steel framed glass shelves
- (1) full-width fixed position stainless steel-framed glass shelf
- (1) MaxStore™ Bin
- (1) stainless steel freezer shelf (removable)

Product Dimensions

23⁷/₈" W x 33³/₄" minimum H x 26¹/₄" D
(including handle)

Finish/Door Options

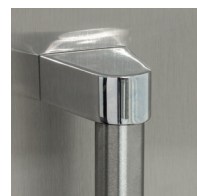

Stainless Steel

Ordering Details	
Solid Stainless Steel Door With Lock, Right Hinge	MO24RFS2RS
Solid Stainless Steel Door With Lock, Right Hinge	MO24RFS2LS
Outdoor Ice Maker Kit	S42418151

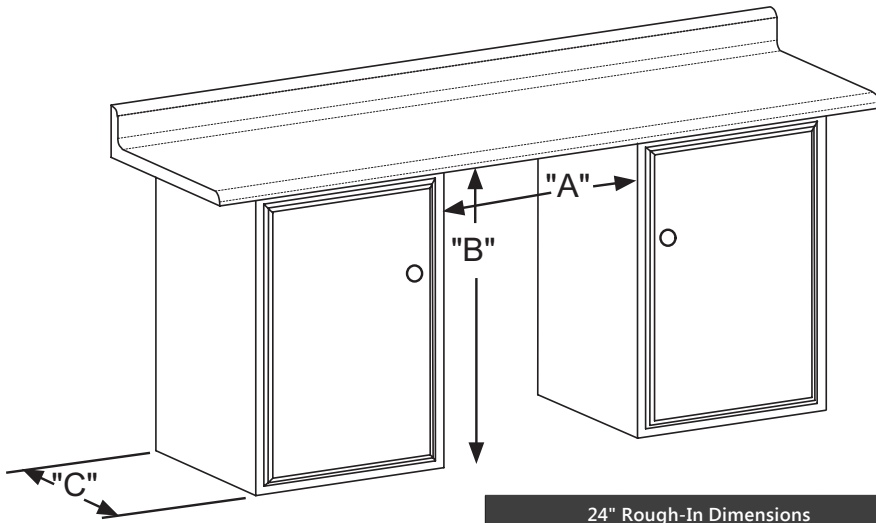

24" Rough-In Dimensions		
"A"	"B"	"C"
24" (61 cm)	34" to 35" (86.4 cm to 88.9 cm)	24" (61 cm)

Cabinet Dimensions					
"D"	"E"	"F"	"G"	"H"	"J"
23 7/8" (60.7 cm)	33 3/4" to 34 3/4" (85.7 to 88.3 cm)	23 23/32" (60.2 cm)	26 7/32" (66.6 cm)	46 13/32" (117.9 cm)	26 7/16" (67.2 cm)

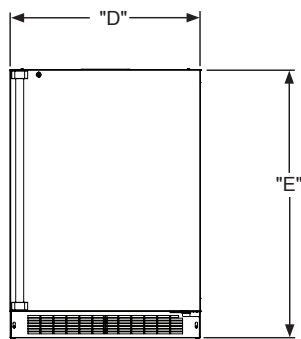
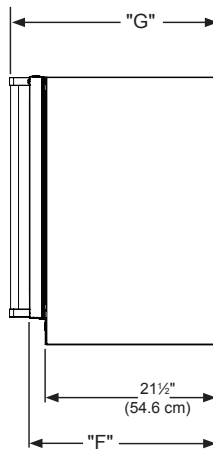
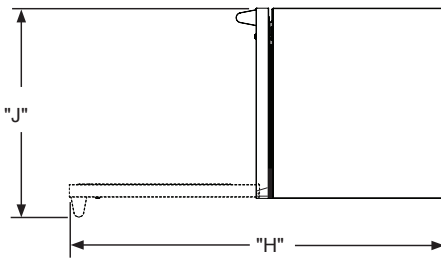

Energy-efficient with precise temperature management

Dynamic Cooling Technology™

Rapidly cools and delivers the industry's best temperature stability

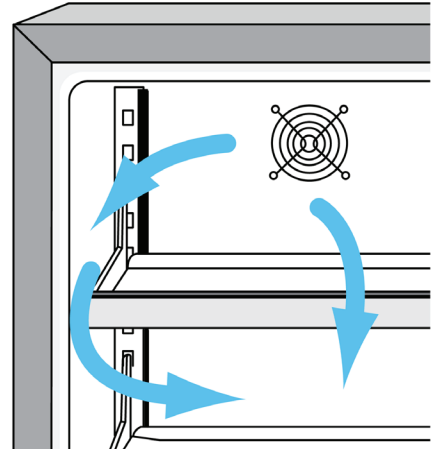

Certified for performance to withstand the elements



Corrosion-resistant stainless steel exterior, sturdy pro-style handle and rugged toe kicks



Security locks standard

Width	23 7/8"
Interior Finish	Arctic White
Capacity	Refrigerator: 3.9 cu. ft. Freezer: 1 cu. ft.
Shelving System	Cantilever
Shelf Fronts	Formed Metal
Other Storage	MaxStore™ Bin
Interior Lighting	White LED Lighting

Handle	Professional
Temperature Range	Refrigerator: 34° to 42° F Freezer: -6° to 6° F
Lock	Yes
Length of Power Cord	6'
Product Dimensions without Door	23 7/8" W x 33 3/4" H x 21 1/2" D

Depth to Front of Door	23 23/32"
Depth to Handle	26 7/32"
Depth with door at 90°	46 13/32"
Shipping Weight	160 lbs
Depth with door at 90°	46 1/2"
Shipping Weight	160 lbs