



DX07 Series

USB Type-C™ Connector

Connector Training Module

Technology to Inspire Innovation



JAE DX07 Series

USB Type-C™ Connector

Application Examples

- Smartphones
- Tablets
- PCs
- Monitors/TVs
- Digital cameras
- Other consumer devices

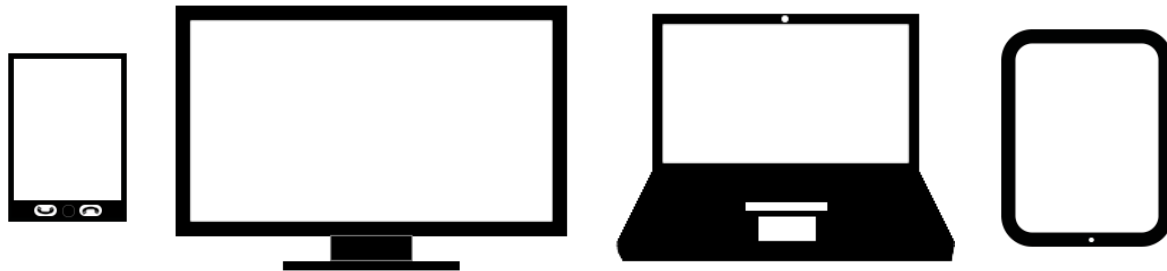

DX07 Series Overview

The next-generation USB Type-C™ interface has been defined by the USB-IF^(Note) for connecting current and future consumer and industrial devices such as mobile phones, various PCs, and imaging devices. It features a reversible plug that enables insertion and removal in the right side up, or up side down orientation. It also supports USB 3.1 transmission speeds of up to 10Gbps, and a maximum of 5A of power. JAE's new family of Type-C™ connectors, the DX07 Series, includes plugs, receptacles, and harnesses.



Note - USB Implementers Forum, Inc. is a non-profit corporation founded by the group of companies that developed the Universal Serial Bus specification.

DX07 Series Features

User friendly – Reversible insertion

- Compatible with Universal Serial Bus (USB) Type-C™ Cable and Connector Specification Release 1.1
- Compatible with 10Gbps, USB 3.1 Gen 2 SuperSpeed communication
- Supports a maximum of 5A and 20V of power for charging
 - Compatible with USB Power Delivery
- Reversible plug allows for easy insertion and removal
- Superior EMI / EMC characteristics with multiple ground contact points
- Friction lock included within plug connector
- Rear shell option available for additional shielding

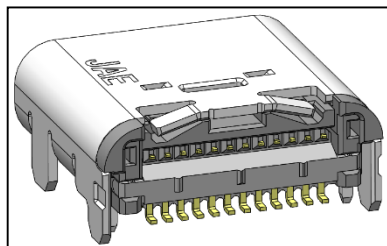

Without rear shell

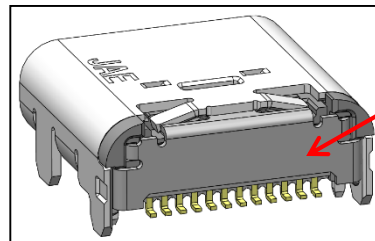

With rear shell

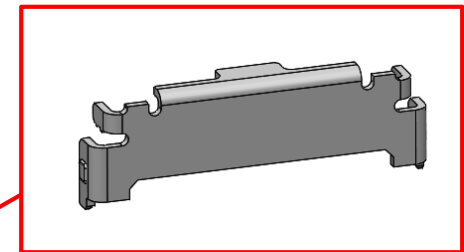

Removable rear shell

General Specifications

No. of Contacts	24
Rated Current	5A max.
Rated Voltage	AC20V r.m.s.
Contact Resistance	40mΩmax. (initial)
Dielectric Withstanding Voltage	AC 100V r.m.s. for 1minute
Insulation Resistance	100MΩmin. (initial)
Operating Temperature Range	-30 Deg. C ~ +80 Deg. C
Mating Durability	10,000 cycles

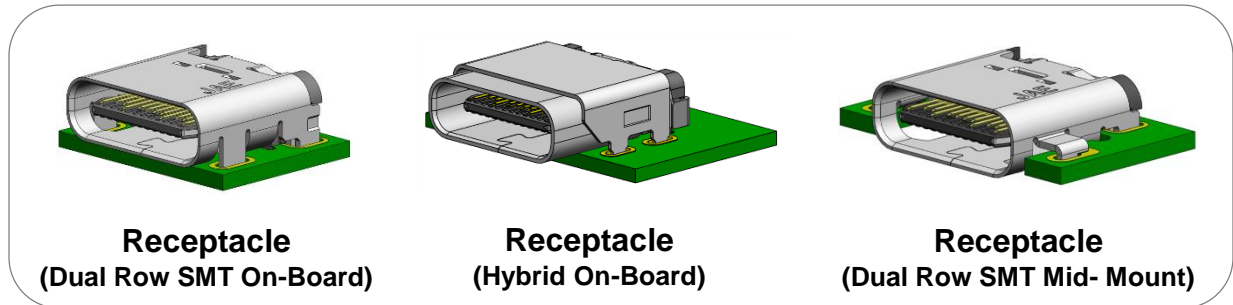
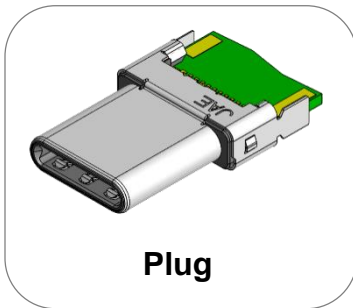

Basic Dimensions

*All units in mm

Plug

p/n: DX07P024MJ1

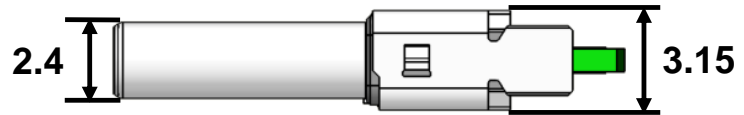
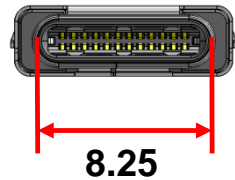
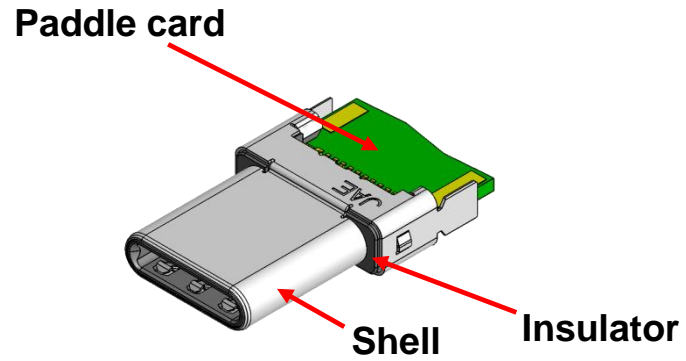
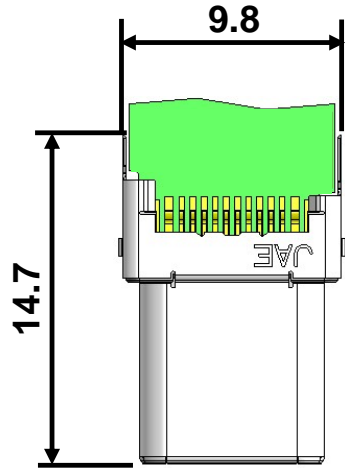

Basic Dimensions

*All units in mm

Receptacle (Dual Row SMT Mid-Mount)

p/n: DX07B024JJ*

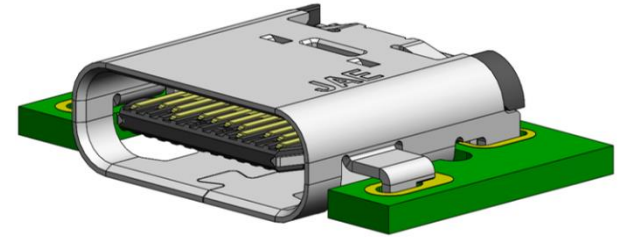
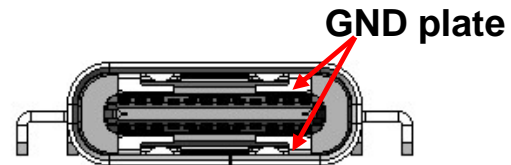
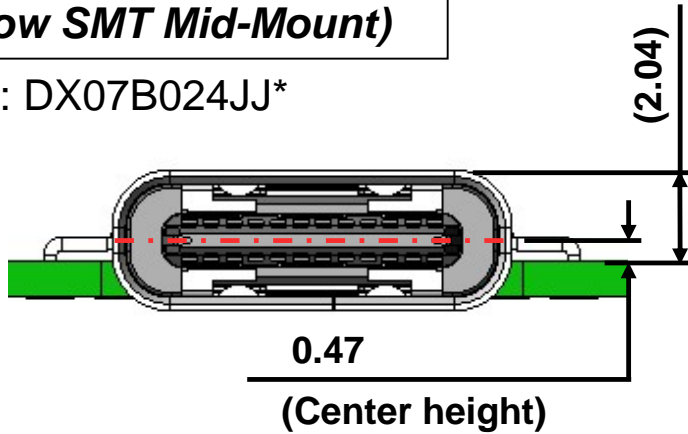

(Dual Row SMT Mid-Mount)

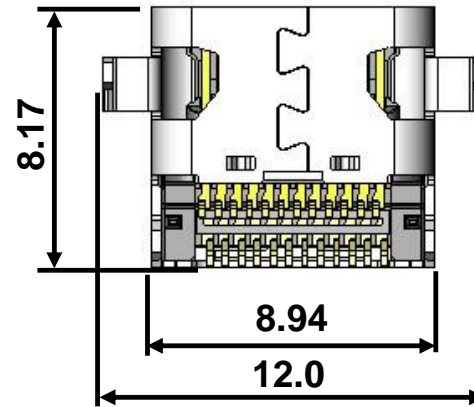
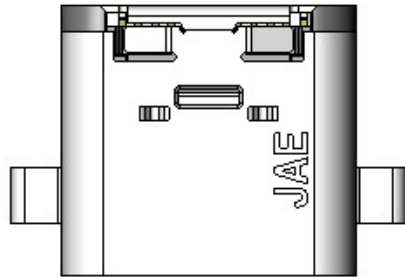

Basic Dimensions

*All units in mm

Receptacle (Dual Row SMT On-board)

p/n: DX07S024JJ*

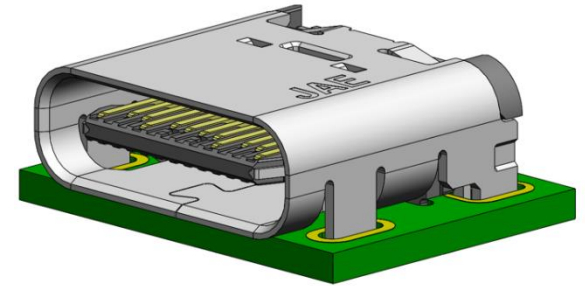

(Dual Row SMT On-board)

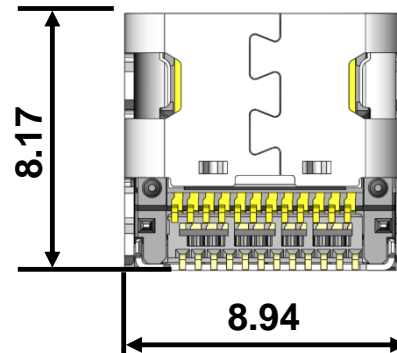
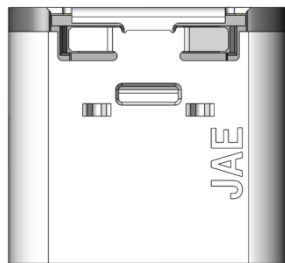
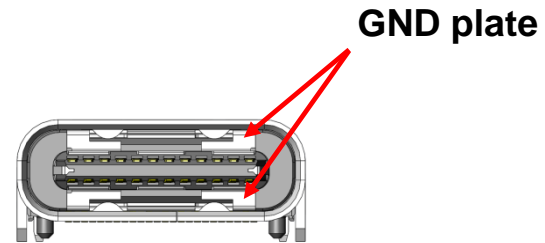
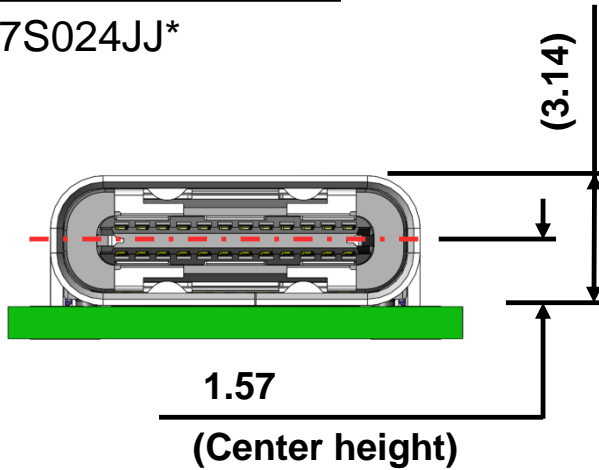

Basic Dimensions (cont.)

*All units in mm

Receptacle (Dual Row SMT On-board)

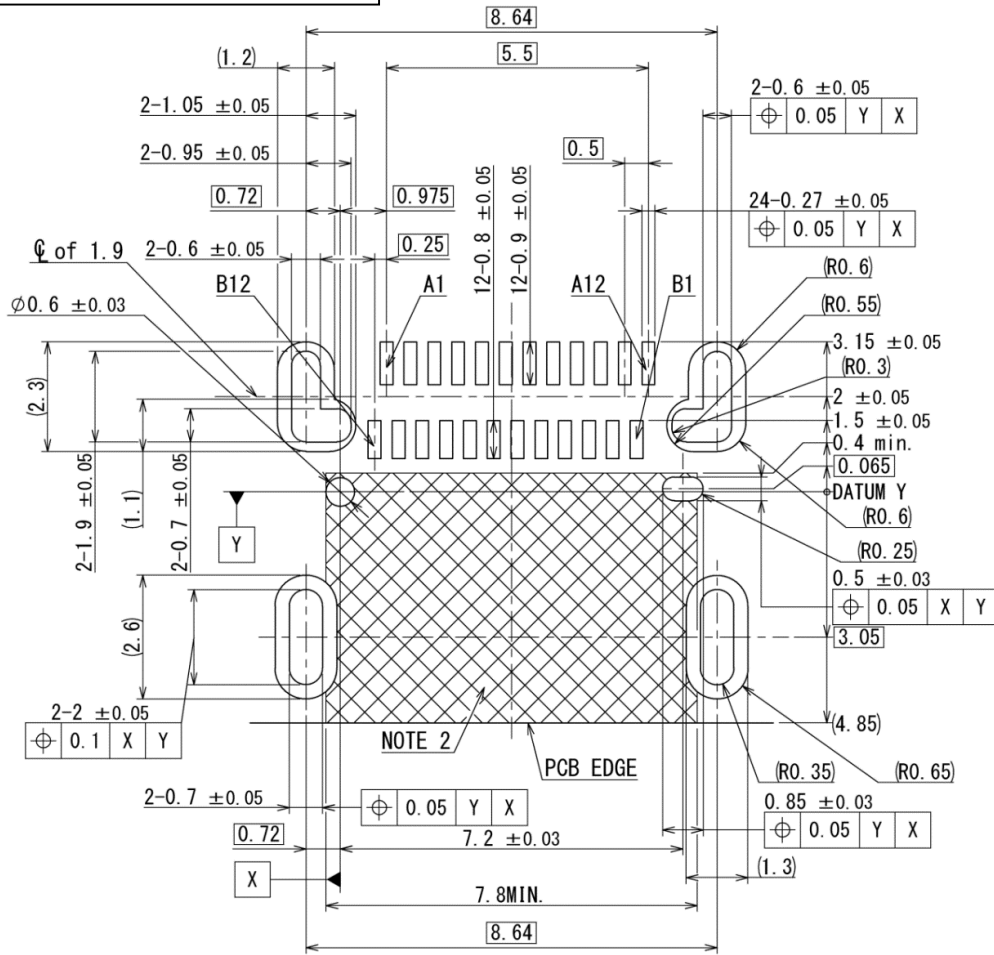

NOTE2. NO PCB ROUTING ALLOWED IN THIS AREA.

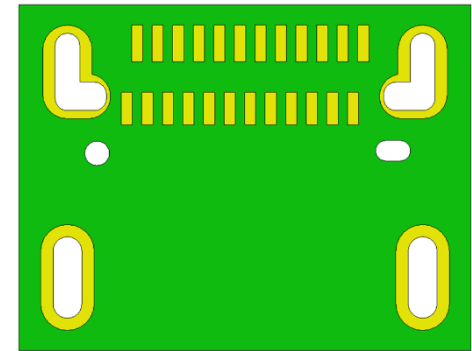
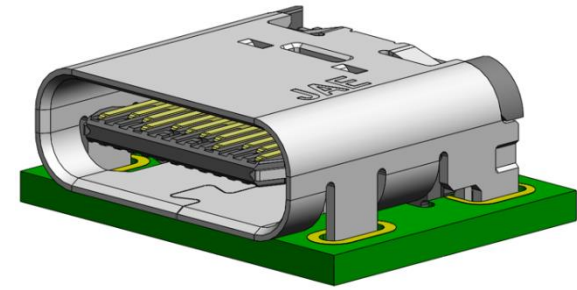

Not compatible with reference footprint on the Type C spec.

Basic Dimensions

*All units in mm

Receptacle (Hybrid On-board)

p/n: DX07S024XJ1

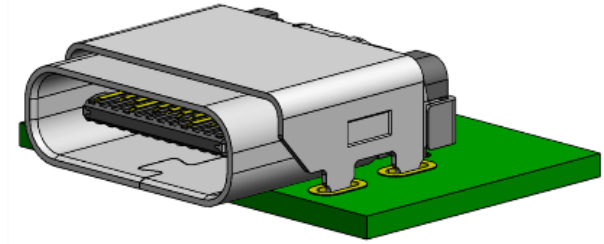

(Hybrid On-board)

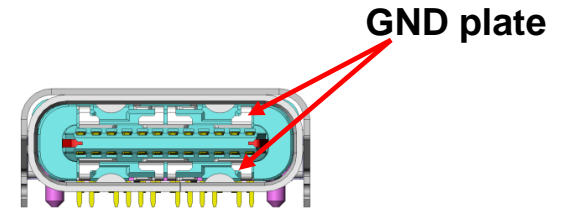
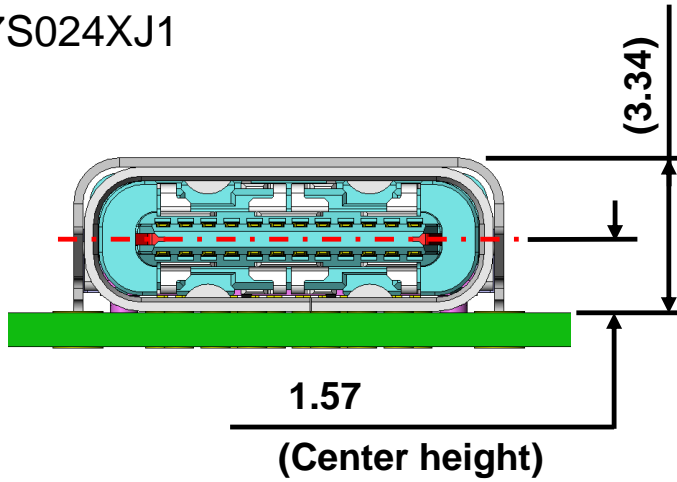

GND plate

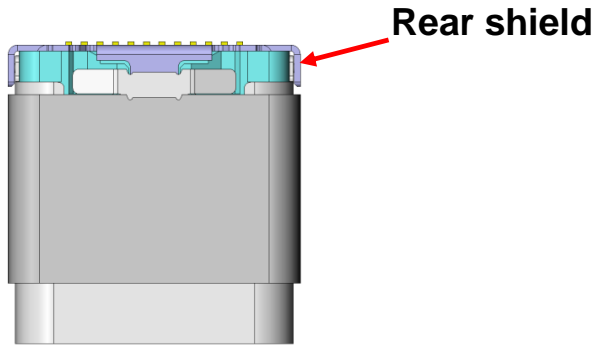

Rear shield

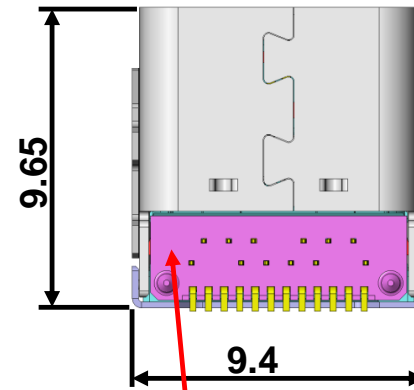

Locator

Materials and Finishes

Component	Material / Finish
Insulators	Heat-Resistant Plastic
Rear Shield (optional)	Stainless Steel w/ Nickel Plating
Shell	Stainless Steel w/ Nickel Plating
Ground Plate	Stainless Steel w/ Nickel Plating
Mid Plate	Stainless Steel w/ Nickel Plating
Contacts	Copper Alloy w/ Contact area: Gold Flash plating over Palladium-Nickel over Nickel Solder tails: Gold Flash plating over Nickel

Ordering Information

	Type	Part Number	Rear Shield
	Plug	DX07P024MJ1	-
Receptacles	Mid-mount type	DX07B024JJ1R1500	Yes
		DX07B024JJ2R1500	No
	On-board type	DX07S024JJ2R1300	Yes
		DX07S024JJ3R1300	No

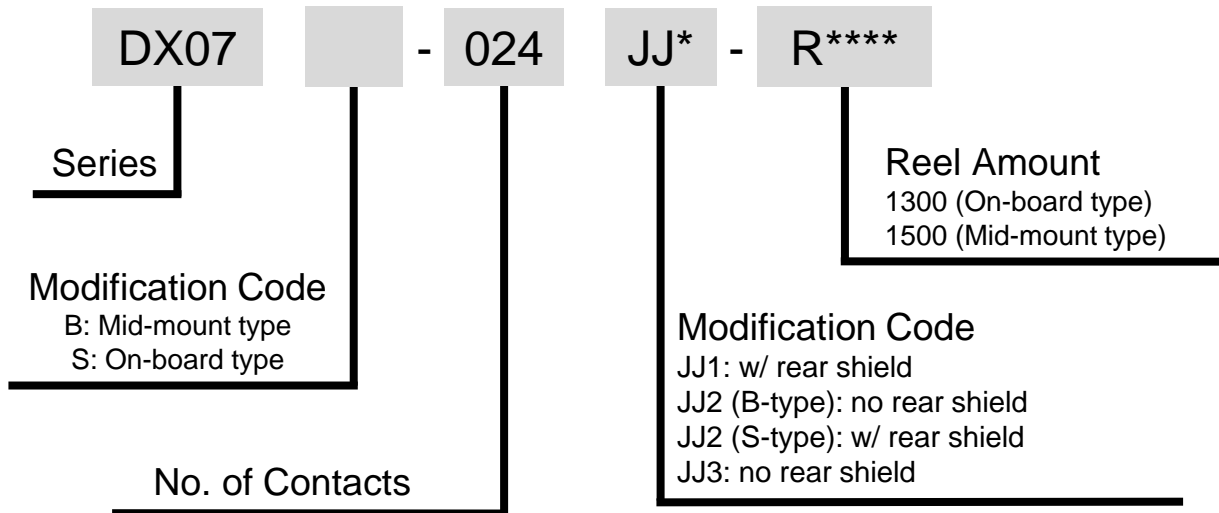

Summary

- USB 3.1 high speed signaling supported
- Mid-mount type and On-board type available
- User-friendly – Reversible insertion
- Optional rear shell
- Friction lock equipped
- Enhanced EMI performance
- Power delivery supported (3A/5A)



Technology to Inspire Innovation

JAE