



DURENDAL LLC

DISTRACT – BALL®



NON-EXPLOSIVE DISTRACTIONARY DEVICE

OPERATING INSTRUCTIONS AND GENERAL INFORMATION

Please refer to these instructions when operating the DISTRACT-BALL®. Instructions are also available through our website at www.durendal-llc.com.

Product Contents:

- One 2.75" dia. DISTRACT-BALL®
- One USB Charging Cord
- One wall charging adapter

General Description

The DISTRACT-BALL® is a hand deployable device that uses high intensity lighting and sound effects as a means of distraction. The lighting effect is provided by two high intensity CREE LED light engines. These light engines are located inside two lensed openings that are located 180 degrees opposite each other on the device. The distractionary sound effect is created by a high power speaker residing inside a resonating cavity in the device. An external Activate Button is provided to Arm the device, triggering the lighting and sound effects. A micro power connector is used for re-charging the batteries via the supplied USB charging adapter, or any convenient USB power supply device such as a laptop, or other device.



Depressing the external Activate Button Arms the DISTRACT-BALL®. Once Armed, the programmed distracting sequence is activated through the internal Micro-Controller Unit (MCU).

Following the Arming event, user feed back is supplied via 2 soft audible clicks for the device. This alerts the user that the DISTRACT-BALL® is Armed and ready to be deployed. If in the event that the device has been Armed and the user would like to abort further operation, simply depressing the Activate Button TWICE, will disable any further distractionary operations from occurring.

After the 2 confirmation clicks, an approximately 2 second no-activity delay commences: it is during this time that the user would normally throw/roll/deploy the DISTRACT-BALL® in the intended target environment. The DISTRACT-BALL's high power speaker starts emitting a 110dB siren like sound at approximately 3KHz for approximately 7 seconds. At this same time, the high intensity CREE LEDs are turned on into a maximum light output Strobe stage while the high power speaker continues to emit sound. Subsequently, the device stops emitting sound and the lighting becomes constant with 80% illumination output: in this mode the device is intended to allow a lighted environment search. The DISTRACT-BALL® will continue to reduce it's light output over time to approximately 50% of maximum, allowing the environment to be continuously lit, and the device to be easily retrieved by the user.

The DISTRACT-BALL® can then be de-activated by depressing the Active Button twice. Now, the DISTRACT-BALL® is ready for the next distracting sequence!

The DISTRACT-BALL® employs rechargeable batteries for an always-ready state. The batteries can be simply charged via the external charging port and can be activated up to fifteen times on a single charge. For optimal results, the device should be re-charged after every use, or extended periods of inactivity, for a minimum of four hours.

Instructions for Use:

1. Please completely charge the device before its first use. Insert the USB cable prong into the unit's micro power connector and connect the cable with the wall charger. Charge the device for four hours minimum before first use. The DISTRACT-BALL® has proven to be capable of operating for many times on a single charge but we suggest re-charging the unit after each use, when possible.
2. **PROPER MODE OF USE:**
 - a. The DISTRACT-BALL® should be used for distracting purposes and as a means of illuminating searching areas, only.
 - b. It should NEVER be used as a toy or deployed while participating in a game.
 - i. Warning! The DISTRACT-BALL® should never be placed directly in front of the eyes as permanent damage to the eyes may occur.
 - ii. Warning! The DISTRACT-BALL® should never be held up to the ears as permanent hearing loss may occur.



- c. To Arm the DISTRRACT-BALL®, press the external Activate Button once. To de-activate the DISTRRACT-BALL® press the external Activate Button twice.
- d. The DISTRRACT-BALL® should primarily be deployed by ROLLING the device; however, it can occasionally be thrown from a maximum height of 3'. Warning, continuous AND/OR multiple throws from 3' or higher onto hard surfaces dramatically increases the risk of damaging the device and nullifies the warranty. See Limited Warranty below.
- e. Depress the external Activate Button and immediately deploy the DISTRRACT-BALL® toward the targeted environment making sure that you are looking/searching **AWAY** from the device's path, especially once the lighting sequence is initiated.
- f. After use and retrieval of the device, the DISTRRACT-BALL® can be immediately re-deployed. During tests, the DISTRRACT-BALL® operated for more than fifteen times on a single charge; however, we suggest to charge the device after each use.
- g. Avoid submerging the device in waters or liquids deeper than 4".
- h. Charge the device with the charging adaptor and cable provided.

- 3. **WARNING! DO NOT THROW THIS DEVICE DIRECTLY AGAINST INDIVIDUALS OR ANIMALS AS SEVERE BODILY HARM CAN OCCUR.**
- 4. **WARNING! THROWING THIS DEVICE CAN CAUSE DAMAGE TO SURROUNDING OBJECTS.**
- 5. **WARNING! LOOKING DIRECTLY AT THE DEVICE'S LED LIGHTS WHILE IN FUNCTION WILL CREATE TEMPORARY BLINDING EFFECT! AND COULD CAUSE DAMAGE TO YOUR EYES!**
- 6. **WARNING! DO NOT ACTIVATE WHILE DRIVING OR OPERATING A MOVING VEHICLE!**
- 7. **WARNING! THE HIGH POWER SPEAKER EMITS A SIREN LIKE SOUND ABOVE 110 DB, WHICH CAN IMPAIR YOUR HEARING AND MAY LEAD TO PERMANENT HEARING LOSS. WEAR EARPLUGS WHEN USING THIS DEVICE IN CLOSE PROXIMITY!**

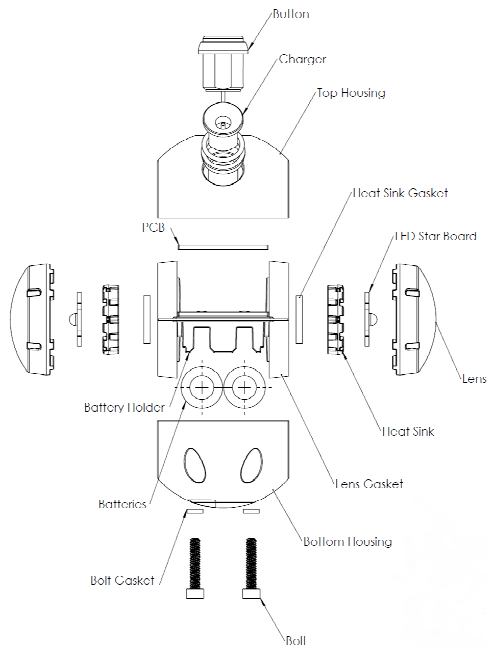

Figure 1

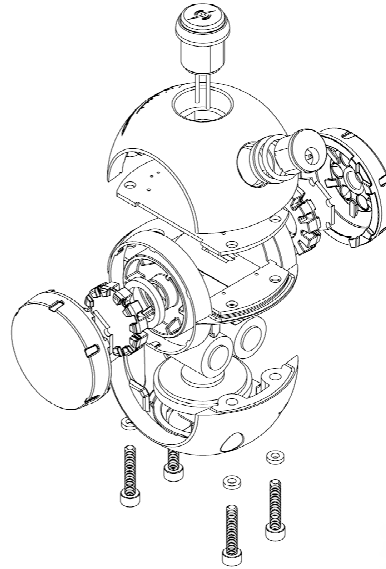

Figure 2

Troubleshooting

If the device displays irregular performance it is most likely a battery related issue. The following is a checklist to assist in troubleshooting the device.

- Charge the device for no less than 4 hours.
- Retest the device.
- If the problem persists call tech support at (855) 228-0761.

Note: There are no user serviceable components inside this device. Service should be performed by a Durendal LLC service representative. The internal batteries employed in this device are polarized: installing them backwards will cause immediate and permanent damage.

LIMITED WARRANTY

Your DISTRACT-BALL® has a 90 day limited warranty against manufacturing defects and workmanship. This warranty does not cover normal wear and tear or abuse.

DISTRACT-BALL® by Durendal LLC
23797 N80th Way
Scottsdale AZ 85255
www.durendal-llc.com