



**APG CASH DRAWER**

**CASH BASES**  **TM**

# **SMART**till™

by **APG CASH DRAWER**

Contact your APG sales representative at (763) 571-5000

**CASH MANAGEMENT SOLUTION**

## A Quantum Change in Cash Management

The **SMARTtill™** Solution is a new revolution in cash management, enabling retailers to eradicate cash losses, reduce the cost of cash handling, and improve in-store productivity. The **SMARTtill™** Solution is an innovative cash management system suitable wherever cash is transacted.

The **SMARTtill™** Intelligent Cash Drawer captures, in real-time, all cash activity at its location. This information is collected without affecting transaction time and without interrupting the retail transaction. The **SMARTtill™** Solution may be integrated with current POS equipment.

The **SMARTtill™** Manager software supports each **SMARTtill™** Solution unit deployed in-store by collecting and aggregating cash transaction information and device connectivity health. In-store cash management activities can be performed with confidence and ease, supported by real-time cash on-hand information. The **SMARTtill™** Manager provides vital reports from each **SMARTtill™** including: current and previous cash values allowing managers to effectively manage cash float within the **SMARTtill™** Manager.

**All your cash counted and secured; bill by bill... coin by coin... second by second**



### Reliable

Tested to last beyond  
1 million operations

### Accurate

100% accurate  
cash value &  
reconciliation data

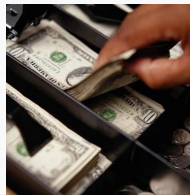

### Easy to install and use

Normal till  
operation for cashier

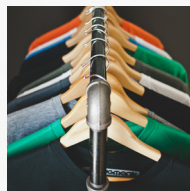

### Fast

Instant discrepancy  
alert, by operator,  
shift and time



INSTALL IT. FORGET IT.

# How Does The **SMARTtill™** Cash Management Solution Work?

by **APG CASH DRAWER**

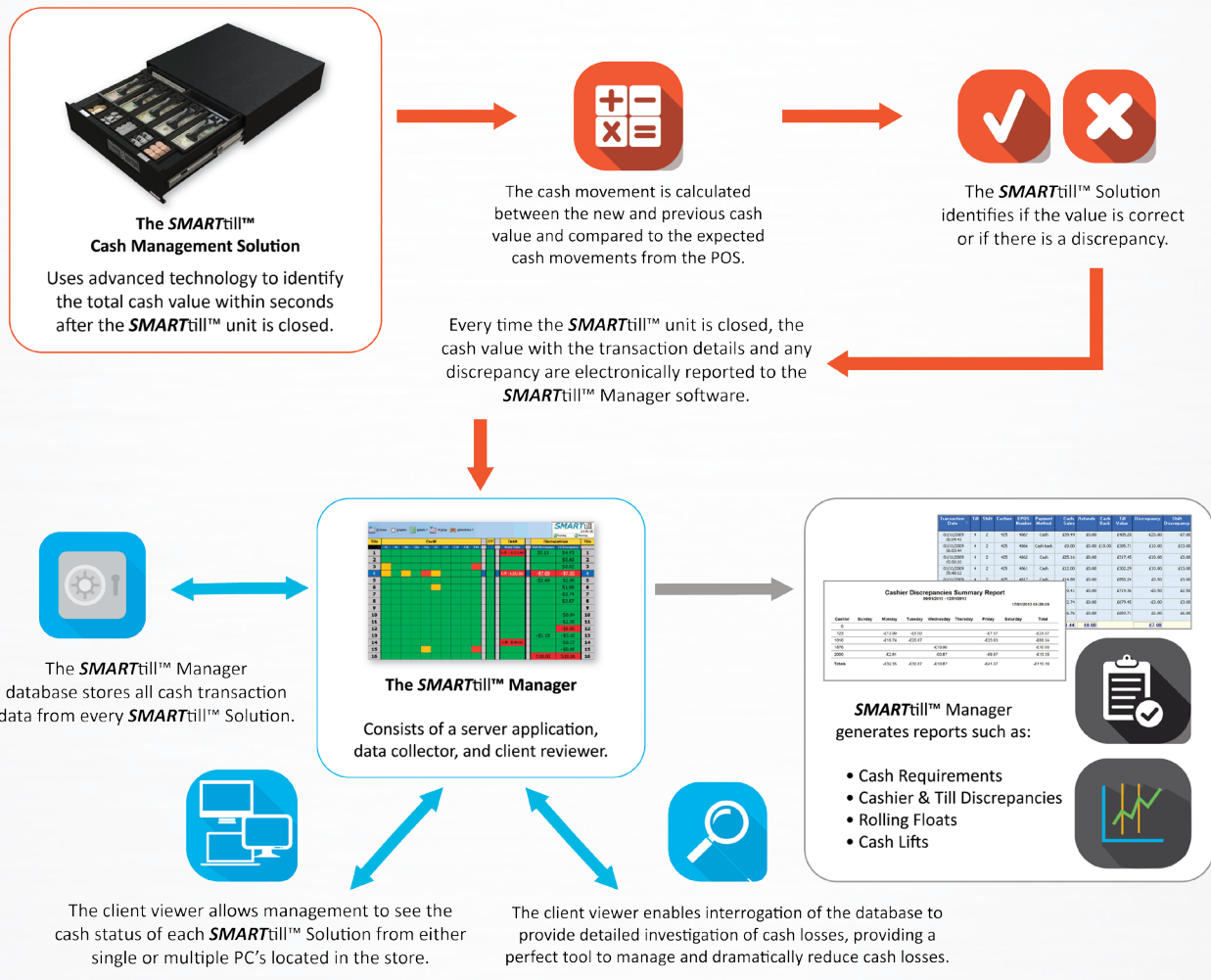

## **SMARTtill™** Cash Management Solution Features:

by **APG CASH DRAWER**

- Size:** (W x D x H)
- 50-SMTSLIDE-441 (17.36 x 16.61 x 4.72) inches (441 x 422 x 120) mm (5 layflat & 2 vertical bill & 5 coin) Manufactured in USA
  - SMTSLIDE-441 (17.36 x 16.61 x 4.72) inches (441 x 422 x 120) mm (5 layflat & 2 vertical bill & 5 coin) Manufactured in UK
- Interfaces:**
- RS232 and built-in USB
  - Standard cash drawer kick out for printer driven configuration
  - Built-in Ethernet connectivity for SMARTtill™ Manager data aggregation
- Till Aspects:**
- Removable coin cups
  - Configurable for multiple currency and denomination
  - Load bearing sensors beneath each coin and bill compartment
- Software:**
- SMARTtill™ Manager software optional
- POS Software Interfaces:**
- Direct command protocol
  - XML file protocol
- Security:**
- No key release
  - Bolt down facility in base
- Optional:**
- Easy to use mounting bracket for quick maintenance