

# PULLPRO™

**NEW  
PRODUCT**

Manufactured by  
**SUNCOR®  
Stainless**

## PREMIUM STAINLESS STEEL BLOCKS

### FIVE ATTACHMENT TYPES

Choose an assembly that meets the needs of your application. Attachment types include a forged swivel eye, "D" shackle, bow shackle, swivel hook and a machined bolt head.

### SHEAVE OPTIONS

PULLPRO™ sheaves were designed with wide sheave grooves that provide a proper throat angle preventing damage to the rope and wear on the sheave groove. Three options available; fibrous rope, LoLoad wire or HiLoad wire.

### MARINE GRADE 316 STAINLESS

Components are made from 316 stainless steel for added durability in harsh environments.

### HUB STYLES

PULLPRO™ block sheaves are offered in 2 hub style options; either lead free, oil impregnated bronze bushing for high load, slow turning applications or 440C hardened stainless steel ball bearings for low friction, high speed applications.

### THREE-WAY HEAD CONFIGURATION

For quick configuration adjustments on site without tools, simply remove the quick release cotter pin and reposition the attachment to a fixed 0° or fixed 90° position and reinstall the pin. A free swivel mode can be accomplished by removing the cotter pin completely.

### DETAILS: 3-Way Head Configuration

- Lock attachment into desired orientation using pin or remove pin to allow fitting to swivel freely.

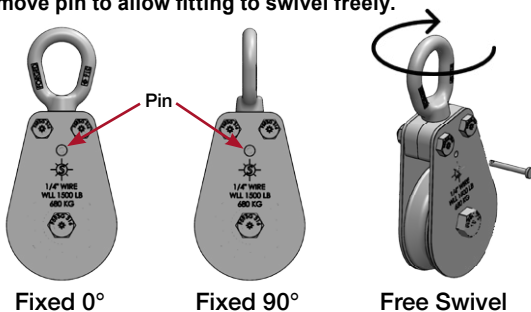

### PULLPRO™ premium stainless steel blocks are:

- Designed to address an industry need for versatile, robust and long-lasting sheaves to meet today's demanding applications.
- Available for fibrous or wire rope and feature either stainless steel ball bearing or bronze bushing type hub styles.
- Comprised of high quality grade 316 stainless steel for maximum corrosion resistance and durability in harsh environments.
- Designed with versatility as a key feature. Blocks feature five attachment types with a unique three-way head configuration that allows a single block to offer versatility and multiple usages.
- Certified through extensive in-house laboratory testing. The WLL represents a 5:1 design factor, and meet ASME B30.26.

# FIBROUS ROPE BLOCKS



## SA BOW SHACKLE BLOCK - ROPE 316 STAINLESS STEEL



ITEM	FIBROUS ROPE SIZE	SHEAVE DIA.	SHACKLE SIZE	WLL (lb)	WT (lb)
<b>BRONZE BUSHING</b>					
S0429-12050-BA1	7/16"	2.00"	5/16" (8mm)	1,000	0.82
S0429-13063-BA1	1/2"	2.50"	3/8" (10mm)	1,500	1.61
S0429-16079-BA1	5/8"	3.13"	15/32" (12mm)	3,000	2.88
S0429-20095-BA1	3/4"	3.75"	5/8" (16mm)	4,000	5.27
S0429-25125-BA1	1"	5.00"	3/4" (20mm)	5,500	11.48
<b>STAINLESS BEARING</b>					
S0430-12050-BA1	7/16"	2.00"	5/16" (8mm)	1,000	0.83
S0430-13063-BA1	1/2"	2.50"	3/8" (10mm)	1,500	1.56
S0430-16079-BA1	5/8"	3.13"	15/32" (12mm)	3,000	2.82
S0430-20095-BA1	3/4"	3.75"	5/8" (16mm)	4,000	5.17
S0430-25125-BA1	1"	5.00"	3/4" (20mm)	5,500	11.25



## SWIVEL EYE BLOCK - ROPE 316 STAINLESS STEEL



ITEM	FIBROUS ROPE SIZE	SHEAVE DIA.	EYE SIZE	WLL (lb)	WT (lb)
<b>BRONZE BUSHING</b>					
S0429-12050-EY1	7/16"	2.00"	5/16"	1,000	0.69
S0429-13063-EY1	1/2"	2.50"	3/8"	1,500	1.34
S0429-16079-EY1	5/8"	3.13"	1/2"	3,000	2.62
S0429-20095-EY1	3/4"	3.75"	5/8"	4,000	4.54
S0429-25125-EY1	1"	5.00"	3/4"	5,500	10.01
<b>STAINLESS BEARING</b>					
S0430-12050-EY1	7/16"	2.00"	5/16"	1,000	0.72
S0430-13063-EY1	1/2"	2.50"	3/8"	1,500	1.29
S0430-16079-EY1	5/8"	3.13"	1/2"	3,000	2.56
S0430-20095-EY1	3/4"	3.75"	5/8"	4,000	4.44
S0430-25125-EY1	1"	5.00"	3/4"	5,500	9.78



## BOLT HEAD BLOCK - ROPE 316 STAINLESS STEEL



ITEM	FIBROUS ROPE SIZE	SHEAVE DIA.	BOLT SIZE	WLL (lb)	WT (lb)
<b>BRONZE BUSHING</b>					
S0429-12050-BH1	7/16"	2.00"	5/16"-18	1,000	0.65
S0429-13063-BH1	1/2"	2.50"	3/8"-16	1,500	1.27
S0429-16079-BH1	5/8"	3.13"	1/2"-13	3,000	2.39
S0429-20095-BH1	3/4"	3.75"	5/8"-11	4,000	4.03
S0429-25125-BH1	1"	5.00"	3/4"-10	5,500	9.28
<b>STAINLESS BEARING</b>					
S0430-12050-BH1	7/16"	2.00"	5/16"-18	1,000	0.66
S0430-13063-BH1	1/2"	2.50"	3/8"-16	1,500	1.22
S0430-16079-BH1	5/8"	3.13"	1/2"-13	3,000	2.33
S0430-20095-BH1	3/4"	3.75"	5/8"-11	4,000	3.93
S0430-25125-BH1	1"	5.00"	3/4"-10	5,500	9.05



## SWIVEL HOOK BLOCK - ROPE 316 STAINLESS STEEL



ITEM	FIBROUS ROPE SIZE	SHEAVE DIA.	WLL (lb)	WT (lb)
<b>BRONZE BUSHING</b>				
S0429-12050-HK1	7/16"	2.00"	1,000	1.14
S0429-13063-HK1	1/2"	2.50"	1,500	1.90
S0429-16079-HK1	5/8"	3.13"	3,000	3.36
S0429-20095-HK1	3/4"	3.75"	4,000	6.06
<b>STAINLESS BEARING</b>				
S0430-12050-HK1	7/16"	2.00"	1,000	1.19
S0430-13063-HK1	1/2"	2.50"	1,500	1.85
S0430-16079-HK1	5/8"	3.13"	3,000	3.30
S0430-20095-HK1	3/4"	3.75"	4,000	5.96



## D SHACKLE BLOCK - ROPE 316 STAINLESS STEEL



ITEM	FIBROUS ROPE SIZE	SHEAVE DIA.	SHACKLE SIZE	WLL (lb)	WT (lb)
<b>BRONZE BUSHING</b>					
S0429-12050-DS1	7/16"	2.00"	5/16" (8mm)	1,000	0.78
S0429-13063-DS1	1/2"	2.50"	3/8" (10mm)	1,500	1.54
S0429-16079-DS1	5/8"	3.13"	15/32" (12mm)	3,000	2.84
S0429-20095-DS1	3/4"	3.75"	5/8" (16mm)	4,000	5.16
S0429-25125-DS1	1"	5.00"	3/4" (20mm)	5,500	11.31
<b>STAINLESS BEARING</b>					
S0430-12050-DS1	7/16"	2.00"	5/16" (8mm)	1,000	0.82
S0430-13063-DS1	1/2"	2.50"	3/8" (10mm)	1,500	1.49
S0430-16079-DS1	5/8"	3.13"	15/32" (12mm)	3,000	2.78
S0430-20095-DS1	3/4"	3.75"	5/8" (16mm)	4,000	5.06
S0430-25125-DS1	1"	5.00"	3/4" (20mm)	5,500	11.08

Manufactured by SUNCOR<sup>®</sup> Stainless

**NOTE:**

MEETS ASME B30.26 SPECIFICATIONS.

ALL DIMENSIONS ARE NOMINAL (+/- 3%) AND ARE SUBJECT TO CHANGE WITHOUT NOTICE.

# LoLOAD WIRE BLOCKS



## SA BOW SHACKLE BLOCK LoLOAD - WIRE 316 STAINLESS STEEL



ITEM	WIRE SIZE	SHEAVE DIA.	SHACKLE SIZE	WLL (lb)	WT (lb)
<b>BRONZE BUSHING</b>					
S0431-05050-BA1	3/16"	2.00"	5/16" (8mm)	1,000	0.78
S0431-07063-BA1	1/4"	2.50"	3/8" (10mm)	1,500	1.62
S0431-08078-BA1	5/16"	3.13"	3/8" (10mm)	2,000	2.98
S0431-10100-BA1	3/8"	4.00"	15/32" (12mm)	3,000	3.68
<b>STAINLESS BEARING</b>					
S0432-05050-BA1	3/16"	2.00"	5/16" (8mm)	1,000	0.81
S0432-07063-BA1	1/4"	2.50"	3/8" (10mm)	1,500	1.59
S0432-08078-BA1	5/16"	3.13"	3/8" (10mm)	2,000	2.91
S0432-10100-BA1	3/8"	4.00"	15/32" (12mm)	3,000	3.70



## SWIVEL EYE BLOCK LoLOAD - WIRE 316 STAINLESS STEEL



ITEM	WIRE SIZE	SHEAVE DIA.	EYE SIZE	WLL (lb)	WT (lb)
<b>BRONZE BUSHING</b>					
S0431-05050-EY1	3/16"	2.00"	5/16"	1,000	0.67
S0431-07063-EY1	1/4"	2.50"	3/8"	1,500	1.35
S0431-08078-EY1	5/16"	3.13"	7/16"	2,000	2.72
S0431-10100-EY1	3/8"	4.00"	1/2"	3,000	3.42
<b>STAINLESS BEARING</b>					
S0432-05050-EY1	3/16"	2.00"	5/16"	1,000	0.70
S0432-07063-EY1	1/4"	2.50"	3/8"	1,500	1.32
S0432-08078-EY1	5/16"	3.13"	7/16"	2,000	2.65
S0432-10100-EY1	3/8"	4.00"	1/2"	3,000	3.44



## BOLT HEAD BLOCK LoLOAD - WIRE 316 STAINLESS STEEL



ITEM	WIRE SIZE	SHEAVE DIA.	BOLT SIZE	WLL (lb)	WT (lb)
<b>BRONZE BUSHING</b>					
S0431-05050-BH1	3/16"	2.00"	5/16"-18	1,000	0.65
S0431-07063-BH1	1/4"	2.50"	3/8"-16	1,500	1.28
S0431-08078-BH1	5/16"	3.13"	1/2"-13	2,000	2.49
S0431-10100-BH1	3/8"	4.00"	1/2"-13	3,000	3.10
<b>STAINLESS BEARING</b>					
S0432-05050-BH1	3/16"	2.00"	5/16"-18	1,000	0.68
S0432-07063-BH1	1/4"	2.50"	3/8"-16	1,500	1.25
S0432-08078-BH1	5/16"	3.13"	1/2"-13	2,000	2.42
S0432-10100-BH1	3/8"	4.00"	1/2"-13	3,000	3.12



## SWIVEL HOOK BLOCK LoLOAD - WIRE 316 STAINLESS STEEL



ITEM	WIRE SIZE	SHEAVE DIA.	WLL (lb)	WT (lb)
<b>BRONZE BUSHING</b>				
S0431-05050-HK1	3/16"	2.00"	1,000	1.14
S0431-07063-HK1	1/4"	2.50"	1,500	1.91
S0431-08078-HK1	5/16"	3.13"	2,000	3.46
S0431-10100-HK1	3/8"	4.00"	3,000	4.63
<b>STAINLESS BEARING</b>				
S0432-05050-HK1	3/16"	2.00"	1,000	1.17
S0432-07063-HK1	1/4"	2.50"	1,500	1.88
S0432-08078-HK1	5/16"	3.13"	2,000	3.39
S0432-10100-HK1	3/8"	4.00"	3,000	4.65



## D SHACKLE BLOCK LoLOAD - WIRE 316 STAINLESS STEEL



ITEM	WIRE SIZE	SHEAVE DIA.	SHACKLE SIZE	WLL (lb)	WT (lb)
<b>BRONZE BUSHING</b>					
S0431-05050-DS1	3/16"	2.00"	5/16" (8mm)	1,000	0.77
S0431-07063-DS1	1/4"	2.50"	3/8" (10mm)	1,500	1.55
S0431-08078-DS1	5/16"	3.13"	3/8" (10mm)	2,000	2.94
S0431-10100-DS1	3/8"	4.00"	15/32" (12mm)	3,000	3.64
<b>STAINLESS BEARING</b>					
S0432-05050-DS1	3/16"	2.00"	5/16" (8mm)	1,000	0.80
S0432-07063-DS1	1/4"	2.50"	3/8" (10mm)	1,500	1.52
S0432-08078-DS1	5/16"	3.13"	3/8" (10mm)	2,000	2.87
S0432-10100-DS1	3/8"	4.00"	15/32" (12mm)	3,000	3.66

Manufactured by SUNCOR<sup>®</sup> Stainless

**NOTE:**

MEETS ASME B30.26 SPECIFICATIONS.

ALL DIMENSIONS ARE NOMINAL (+/- 3%) AND ARE SUBJECT TO CHANGE WITHOUT NOTICE.

# HiLOAD WIRE BLOCKS



## SA BOW SHACKLE BLOCK HiLOAD - WIRE 316 STAINLESS STEEL



ITEM	WIRE SIZE	SHEAVE DIA.	SHACKLE SIZE	WLL (lb)	WT (lb)
<b>BRONZE BUSHING</b>					
S0433-03050-BA1	1/8"	2.00"	1/4" (6mm)	500	0.49
S0433-05075-BA1	3/16"	3.00"	3/8" (10mm)	1,500	1.79
S0433-07100-BA1	1/4"	4.00"	3/8" (10mm)	2,000	3.25
S0433-08125-BA1	5/16"	5.00"	15/32" (12mm)	3,000	4.53
S0433-10150-BA1	3/8"	6.00"	5/8" (16mm)	4,000	8.48
<b>STAINLESS BEARING</b>					
S0434-03050-BA1	1/8"	2.00"	1/4" (6mm)	500	0.51
S0434-05075-BA1	3/16"	3.00"	3/8" (10mm)	1,500	1.79
S0434-07100-BA1	1/4"	4.00"	3/8" (10mm)	2,000	3.20
S0434-08125-BA1	5/16"	5.00"	15/32" (12mm)	3,000	4.47
S0434-10150-BA1	3/8"	6.00"	5/8" (16mm)	4,000	8.51



## SWIVEL EYE BLOCK HiLOAD - WIRE 316 STAINLESS STEEL



ITEM	WIRE SIZE	SHEAVE DIA.	EYE SIZE	WLL (lb)	WT (lb)
<b>BRONZE BUSHING</b>					
S0433-03050-EY1	1/8"	2.00"	1/4"	500	0.44
S0433-05075-EY1	3/16"	3.00"	3/8"	1,500	1.52
S0433-07100-EY1	1/4"	4.00"	7/16"	2,000	3.13
S0433-08125-EY1	5/16"	5.00"	1/2"	3,000	4.27
S0433-10150-EY1	3/8"	6.00"	5/8"	4,000	7.74
<b>STAINLESS BEARING</b>					
S0434-03050-EY1	1/8"	2.00"	1/4"	500	0.46
S0434-05075-EY1	3/16"	3.00"	3/8"	1,500	1.52
S0434-07100-EY1	1/4"	4.00"	7/16"	2,000	3.08
S0434-08125-EY1	5/16"	5.00"	1/2"	3,000	4.21
S0434-10150-EY1	3/8"	6.00"	5/8"	4,000	7.77



## BOLT HEAD BLOCK HiLOAD - WIRE 316 STAINLESS STEEL



ITEM	WIRE SIZE	SHEAVE DIA.	BOLT SIZE	WLL (lb)	WT (lb)
<b>BRONZE BUSHING</b>					
S0433-03050-BH1	1/8"	2.00"	1/4"-20	500	0.43
S0433-05075-BH1	3/16"	3.00"	3/8"-16	1,500	1.45
S0433-07100-BH1	1/4"	4.00"	1/2"-13	2,000	3.05
S0433-08125-BH1	5/16"	5.00"	1/2"-13	3,000	4.02
S0433-10150-BH1	3/8"	6.00"	5/8"-11	4,000	7.29
<b>STAINLESS BEARING</b>					
S0434-03050-BH1	1/8"	2.00"	1/4"-20	500	0.45
S0434-05075-BH1	3/16"	3.00"	3/8"-16	1,500	1.44
S0434-07100-BH1	1/4"	4.00"	1/2"-13	2,000	3.00
S0434-08125-BH1	5/16"	5.00"	1/2"-13	3,000	3.96
S0434-10150-BH1	3/8"	6.00"	5/8"-11	4,000	7.32



## SWIVEL HOOK BLOCK HiLOAD - WIRE 316 STAINLESS STEEL



ITEM	WIRE SIZE	SHEAVE DIA.	WLL (lb)	WT (lb)
<b>BRONZE BUSHING</b>				
S0433-03050-HK1	1/8"	2.00"	500	0.76
S0433-05075-HK1	3/16"	3.00"	1,500	2.08
S0433-07100-HK1	1/4"	4.00"	2,000	4.04
S0433-08125-HK1	5/16"	5.00"	3,000	5.48
S0433-10150-HK1	3/8"	6.00"	4,000	9.26
<b>STAINLESS BEARING</b>				
S0434-03050-HK1	1/8"	2.00"	500	0.78
S0434-05075-HK1	3/16"	3.00"	1,500	2.08
S0434-07100-HK1	1/4"	4.00"	2,000	3.99
S0434-08125-HK1	5/16"	5.00"	3,000	5.42
S0434-10150-HK1	3/8"	6.00"	4,000	9.29



## D SHACKLE BLOCK HiLOAD - WIRE 316 STAINLESS STEEL



ITEM	WIRE SIZE	SHEAVE DIA.	SHACKLE SIZE	WLL (lb)	WT (lb)
<b>BRONZE BUSHING</b>					
S0433-03050-DS1	1/8"	2.00"	1/4" (6mm)	500	0.48
S0433-05075-DS1	3/16"	3.00"	3/8" (10mm)	1,500	1.72
S0433-07100-DS1	1/4"	4.00"	3/8" (10mm)	2,000	3.23
S0433-08125-DS1	5/16"	5.00"	15/32" (12mm)	3,000	4.49
S0433-10150-DS1	3/8"	6.00"	5/8" (16mm)	4,000	8.37
<b>STAINLESS BEARING</b>					
S0434-03050-DS1	1/8"	2.00"	1/4" (6mm)	500	0.50
S0434-05075-DS1	3/16"	3.00"	3/8" (10mm)	1,500	1.72
S0434-07100-DS1	1/4"	4.00"	3/8" (10mm)	2,000	3.18
S0434-08125-DS1	5/16"	5.00"	15/32" (12mm)	3,000	4.43
S0434-10150-DS1	3/8"	6.00"	5/8" (16mm)	4,000	8.40

Manufactured by SUNCOR<sup>®</sup> Stainless

**NOTE:**

MEETS ASME B30.26 SPECIFICATIONS.

ALL DIMENSIONS ARE NOMINAL (+/- 3%) AND ARE SUBJECT TO CHANGE WITHOUT NOTICE.